

# JAGUAR S-TYPE

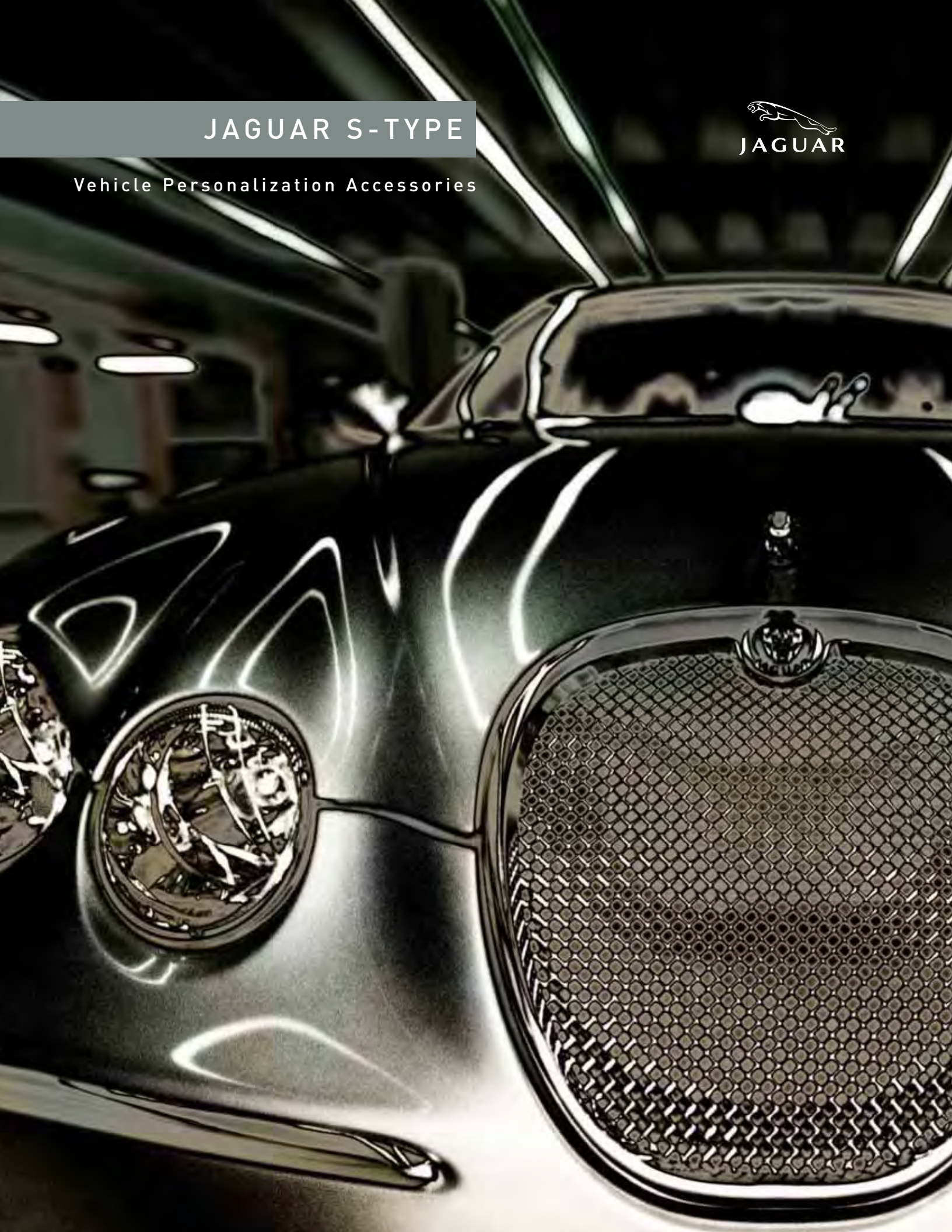

Vehicle Personalization Accessories





## CONTENTS

WHEELS	2
R PERFORMANCE	6
EXTERIOR	8
TECHNOLOGY / ENTERTAINMENT	14
INTERIOR ACCENTS	16
SAFETY / CAR CARE	22
ENGINEERED FOR EXCELLENCE	24

# G o r g e o u s a d d i t i o n s

**THROUGH ITS UNIQUE COMBINATION OF EXQUISITE LUXURY**, sterling design and athletic performance, your S-TYPE provides a timeless and substantive driving experience. Enhance that experience by considering Jaguar-approved accessories that augment your S-TYPE's appearance and functionality.

From attractive alloy wheels to state-of-the-art audio/visual technology to customized roof carriers, Jaguar accessories enable you to personalize your S-TYPE according to your individual taste. And, because these accessories are all approved by Jaguar, you can confidently select them knowing they have undergone rigorous testing to meet the same demanding engineering standards as your S-TYPE.

Consider the accessories described in this brochure and imagine how they can complement your S-TYPE ownership experience. As always, your authorized Jaguar dealer stands ready to consult with you and address any questions you may have.

# WHEELS

ALLOY WHEELS ADD A DISTINCTIVE, sporty design cue to your sleek S-TYPE. Engineered for both durability and appeal, they exude performance and style.



**AURORA 17"**  
XR8 31512



**MELBOURNE 18"**  
C2S 16590



**JUNO 17"**  
XR8 31511



**VALENCIA 18"**  
XR8 52046



**ARTEMIS 16"**  
XR8 43322



**HERAKLES 17"**  
XR8 43330



**HELIOS 16"**  
XR8 17325



**SPIRIT 16"**  
XR8 43323



**KRONOS 17"**  
XR8 17328



**SPORTS 17"**  
XR8 43333



**MERCURY 18"**  
XR8 42129



**BARCELONA 19"**  
Front XR8 53029  
Rear XR8 51963



**TRITON 18"**  
**XR8 31513**

**NOTE:** Wheels may require different tires. Ask your Jaguar sales consultant for details. Center caps and wheel nuts not included.



**SNOW TRACTION CONTROL**

For those having to contend with wintry conditions, Jaguar offers snow chains that can be easily installed along the road. A special "Spike Spider" design provides instant traction on snow, ice or mud. Sold in sets of two.

**XR8 36517**



**ALLOY WHEEL LOCKING WHEEL NUTS**

Help protect your attractive wheels with Locking Wheel Nuts that can only be removed with a special tool that comes with the kit.

**C2S 17485**

## R PERFORMANCE

YOUR S-TYPE HAILS FROM A CAR COMPANY WHOSE LINEAGE IS ROOTED IN RACING and modern performance technology. Celebrate that exclusive heritage with Jaguar R Performance accessories.



**MONACO 18" (SILVER)**  
XR8 26421

**MONACO 18" (OYSTER)**  
XR8 26637



**INDIANAPOLIS 18"**  
XR8 28714





**VULCAN 18" (8" X 18") FRONT**  
XR8 31514

**VULCAN 18" (9.5" X 18") REAR**  
XR8 31515



**ZEUS 18" (8" X 18") FRONT**  
XR8 43331

**ZEUS 18" (9.5" X 18") REAR**  
XR8 43332



**R PERFORMANCE EXHAUST SYSTEM**

Nothing says performance like the throaty roar of Jaguar's R Performance Exhaust System. [Note: Only available on V6 models from VIN M45256.]

**XR8 47124**

# EXTERIOR

ACCENTUATE YOUR JAGUAR WITH THE S-TYPE SPORTS COLLECTION, accessories that illuminate Jaguar's performance heritage. Other exterior accessories include roof bars and carriers to support your lifestyle pursuits and protective guards to help preserve your vehicle's luster.



These elements of the S-TYPE Sports Collection Body Kit can be purchased individually.

## MESH GRILLES

Add a sporty, distinguished design cue to your Jaguar with Mesh Grilles. Specifically designed to complement your S-TYPE's sleek appearance, these finely woven grilles are available in a black or bright finish.

### UPPER MESH GRILLES (FRONT)

Black finish with primed surrounds	XR8 54191 XXX
Black finish with chrome surrounds	XR8 54196
Bright finish with primed surrounds	XR8 47243 XXX
Bright finish with chrome surrounds	XR8 54804

### LOWER MESH GRILLES (FRONT)

Black finish for middle	XR8 54313
Black finish for left	XR8 54311
Black finish for right	XR8 54312
Bright finish for middle	XR8 54846
Bright finish for left	XR8 54844
Bright finish for right	XR8 54845

REAR TRUNK LID SPOILER	XR8 54063 XXX
------------------------	---------------

EXHAUST FINISHER (ONE)	XR8 54054
------------------------	-----------

The following Sports Collection accessories require complete Body Kit installation to ensure optimal aerodynamics:

SIDE SILL (RH)	XR8 54064 XXX
SIDE SILL (LH)	XR8 54065 XXX
FRONT SPOILER	XR8 54062 XXX
REAR MESH GRILLE (BLACK)	XR8 54314
REAR MESH GRILLE (BRIGHT)	XR8 54847
GROWLER BADGE FOR FRONT GRILLE	XR8 51456
REAR VALENCE FOR 2005 MY (VIN N13089) & BEYOND	XR8 54066 XXX

(Note: The S-TYPE Sports Collection does not fit the Supercharged S-TYPE R.)



**LICENSE PLATE FRAMES (SLIMLINE)**

Outline your S-TYPE's license plate with a sporty, durable frame.

<b>Black Pearl</b>	<b>XR8 38398</b>
<b>Gold</b>	<b>C2A 1179</b>
<b>Black</b>	<b>C2A 1178</b>
<b>Polished</b>	<b>C2A 1177</b>

**LICENSE PLATE FRAMES (JAGUAR LOGO)**

Trumpet your S-TYPE ownership with this durable license plate frame featuring the Jaguar logo.

<b>Black Pearl</b>	<b>XR8 38397</b>
<b>Gold</b>	<b>C2A 1176</b>
<b>Black</b>	<b>C2A 1175</b>
<b>Polished</b>	<b>C2A 1173</b>

**R PERFORMANCE PLATE FRAMES**

Accent Jaguar's R Performance Series with a durable stainless steel plate frame

<b>Black surround with R Performance logo</b>	<b>C2C 20093</b>
<b>Polished surround with R Performance logo</b>	<b>C2C 20092</b>

**JAGUAR "LEAPER" PLATES**

Add an exclusive touch to your vehicle with a stainless steel plate featuring Jaguar's classic "Leaper" logo.

<b>Black with polished Leaper</b>	<b>C2A 1180</b>
<b>Polished with gold Leaper</b>	<b>C2A 1181</b>
<b>Polished with polished Leaper</b>	<b>C2C 20588</b>
<b>Polished with black Leaper</b>	<b>C2A 1182</b>

**A REFLECTION OF YOUR PERSONALITY**, your S-TYPE supports your lifestyle and activities with elegance and dependability. Choose from the following sampling of Jaguar's state-of-the-art roof bars and carriers — all of which can be quickly mounted or removed from your vehicle.



#### **ROOF BARS**

These durable Roof Bars support the different cargo carriers available for your S-TYPE. Sold in sets of two.

**XR8 49709**



#### **SPORT BOX**

Sporting gear fits nicely in this lockable carrier, measuring 74" long x 35" wide x 14" tall. Access from the driver or passenger side when mounted to the roof bars. Note: Total roof weight capacity, including box, can not exceed 167 lbs. (75 kg).

**C2A 1460**



#### **SKI/SNOWBOARD CARRIER**

Carry up to six pairs of skis or four snowboards with this durable, lockable carrier. Or, expand your activities by transporting three pairs of skis and two snowboards simultaneously. Requires Roof Bars.

**C2A 1249**



### **BICYCLE CARRIER**

This durable carrier enables you to transport your bicycle or mountain bike. Your S-TYPE Roof Bars (required) are designed to hold up to four Bicycle Carriers.

**C2A 1471**



### **FORK-MOUNT BIKE CARRIER**

For front wheel removal. Requires Roof Bars. (Not pictured.)

**C2A 1248**

### **SURFBOARD/KAYAK/SAILBOARD CARRIER**

Transport up to two boards or kayaks with this sturdy, lockable carrier. Your S-TYPE's roof bars (required) are engineered to hold up to two carriers.

**C2A 1352**



### **LUGGAGE ROOF TRAY**

Secure important cargo with this well constructed unit that includes raised sides and a crossbar floor. Features dimensions of 41" x 40" x 2.5" (104 cm x 101 cm x 6 cm) with an interior width of 38" and an interior length of 39". Along with roof bars, the frame can hold up to 220 pounds (100 kg).

**C2A 1245**



### **FRONT HOOD PROTECTOR**

Shield your S-TYPE's front end from small stones and other road debris with this felt-lined, durable mask that fits snugly over your vehicle's front end. (Note: This accessory can not be used on S-TYPES equipped with the Front Park Aid or Headlamp Washers, nor will it fit the S-TYPE R model.)

**JAG 755**



#### **SIDE WINDOW DEFLECTORS**

Limit wind noise while driving with your windows open by utilizing these unobtrusive deflectors.

**XR8 35541**



#### **HEADLAMP COVERS**

Help shield your S-TYPE's headlamps with these clear, chip-resistant covers. No tools are needed for installation or removal — the covers conveniently slip over your Jaguar's headlamps.

**JLM 20848**



#### **FOG LAMP COVERS**

Designed to conveniently slip over your S-TYPE's fog lamps, these durable clear covers help protect against small stones and road debris. (Not pictured.)

**XR8 28884**

#### **POWER FOLDING MIRRORS**

Ideal for tight parking spaces or automatic car washes, driver-operated Power Folding Mirrors provide peace of mind for the S-TYPE owner. See your dealer for details. Fits S-TYPEs from VIN M45255 (up to 2006 model year only).

**XR8 35553**



### **SPLASH GUARDS**

Help protect your vehicle from mud, dirt, stones and small road debris with Splash Guards designed specifically for your S-TYPE. Front and rear guards sold separately. (Note: Front guards won't fit the R model.)

<b>Front guards</b>	<b>XR8 28879</b>
<b>Rear guards</b>	<b>XR8 28885</b>



### **CHROME MIRROR KIT**

Add a distinctive finishing touch to your side-view mirrors with stylish chrome caps. Fits 2006 model year and beyond.

<b>Righthand</b>	<b>C2P9341</b>
<b>Lefthand</b>	<b>C2P9342</b>

### **CAR COVER**

For indoor or outdoor use, this waterproof Car Cover (lefthand cover in photo) shelters your S-TYPE from the elements or indoor dust. Conveniently folds for packing in its storage bag when not in use.

**C2S 1010**

### **HOT CLIMATE CAR COVER**

Help protect your S-TYPE from damaging UV rays while limiting the vehicle's interior temperature with this lightweight cover (righthand cover in photo).

**C2S 13921**



# TECHNOLOGY/ENTERTAINMENT

**ENGAGE YOUR SENSES** with exclusive Jaguar audio and visual technology.



## REAR SEAT CONNECTIVITY SYSTEM

Rear seat passengers can enjoy electronic devices such as DVD players, camcorders, games and MP3 players via two LCD screens seamlessly integrated into the rear of your S-TYPE's front seat headrests. This innovative technology also features a slot for memory cards that can be used with MP3 players and files, pocket PCs, PSPs (to store photos) and videos. The dual-input system and wireless headphones enable rear seat passengers to enjoy two different audio/visual devices at the same time. Fits 2007 model year and onward.

**Plain Leather (Ivory)**  
**Plain Leather (Charcoal)**  
**Plain Leather (Champagne)**

**XR855898NED**  
**XR855898LEG**  
**XR855898SEL**



## SIRIUS SATELLITE RADIO

Enjoy remarkable audio choices with dealer-installed Sirius Satellite Radio. The system's unit replaces your S-TYPE's ash tray for an integrated look.

**NOTE:** The system receiver and kit prices do not include the subscription fee for the service. See your dealer for subscription activation details. Fits 2003 model year onward. Limited availability; see dealer for details.

**Receiver kit**  
**Installation kit**

**C2C 31222**  
**XR8 54310**



*SIRIUS and related marks are trademarks of SIRIUS Satellite Radio, Inc.*





### AUDIO CONNECTIVITY MODULE

Enhance your driving experience by enjoying playback of any digital audio device (MP3 player, CD player, iPod®, USB memory stick, etc.) through your S-TYPE's entertainment system. With Jaguar's Audio Connectivity Module, USB memory sticks and iPods can be operated from the center console or steering wheel-mounted controls. Conveniently located in your vehicle's center armrest, the system houses all necessary audio wires/cables while ensuring clear sound quality. Fits 2003 model year and beyond.

**C2S 44674**



### BLUETOOTH CONNECTIVITY MODULE

Enjoy hands-free use of compatible Bluetooth-enabled mobile phones without the use of cables, plugs, docking stations or an external antenna. Available on 2003 model year S-TYPEs from VIN M89854.

<b>Bluetooth Module</b>	<b>C2S 43926</b>
<b>PSE Module</b>	<b>C2C 25674</b>

For the most current list of Bluetooth-enabled mobile phones that are compatible with this Jaguar accessory, consult your authorized Jaguar dealer.



### JAGUAR VOICE ACTIVATION SYSTEM

Speak up to get the system installed in your S-TYPE as an accessory. Voice-activated commands will allow you to operate the V60i phone system, CD player, radio, heating and air conditioning.

<b>Voice Module From VIN M89186 To N27446</b>	<b>XR8 44365</b>
<b>Voice Module From VIN N27447</b>	<b>XR8 49645</b>
<b>Fitting Kit From VIN L00450 To M45254</b>	<b>XR8 29732</b>
<b>Fitting Kit From VIN M45255</b>	<b>XR8 36179</b>

*iPod® is a registered trademark of Apple Computer, Inc.*

# INTERIOR

ADD A TOUCH OF PERFORMANCE or protection to your S-TYPE.



## GEAR SHIFT KNOBS

Experience the essence of Jaguar performance by selecting from a range of S-TYPE Gear Shift Knobs, each crafted to complement your vehicle's interior according to your personal taste.

**Alloy**  
JLM 20501



Alloy with chrome insert

**Alloy with chrome insert**  
JAG 1013



Alloy with gold insert

**Alloy with gold insert**  
JAG 1014



Wood walnut

**Chromed alloy gear shift knob**  
C2A 1240



Wood walnut with chrome insert

**Wood walnut**  
MNA 4957 BA



Wood walnut with gold insert

**Wood walnut with chrome insert**  
JAG 162

**Wood walnut with gold insert**  
JAG 164

**Wood smoke grey**  
MNA 4957 CA



Wood smoke grey

**Leather (Charcoal)**  
MJA 4950 AA/LEG



Leather (Charcoal)



Momo



Leather Gear Knob Charcoal



Brush Aluminum  
With Growler Top



All-Wood Grey Stained



All-Wood Walnut

**Momo (Sable)** (Not pictured.)  
MXD 4950 AA/AEK

**Momo (Antelope)** (Not pictured.)  
MXD 4950 AA/AGE

**Momo (Warm Charcoal)**  
MXD 4950 AA/LEG

**Leather Gear Knob Charcoal**  
C2P 6968 LEG

**Collar required for Leather Gear Knob  
Charcoal  
(before VIN M45254)**  
XR8 33620

**Brush Aluminum with Growler Top**  
C2P9343

**All-Wood Walnut**  
C2C 7907

**All-Wood Grey Stained**  
C2S 16404

### ALL-LEATHER SPORTS STEERING WHEEL

Feel the sporty performance of your S-TYPE through this charcoal leather-wrapped steering wheel featuring a perforated grip area. (Not pictured.)

**Black with switches**                      **C2C 17336 LEG**

**Black without switches  
from VIN M45255**                      **XR8 43098 LEG**



### WOOD & LEATHER STEERING WHEEL

This elegant steering wheel — framed in Bird's Eye Maple — conveys the timeless style of Jaguar and can be ordered to match your S-TYPE's interior color. Includes raised thumb locators for driver convenience.

**Sable**                      **XR8 43099 AEK**  
**Charcoal**                      **XR8 43099 LEG**  
**Granite**                      **XR8 43099 LGP**



### ALL-WOOD STEERING WHEEL

For a classic look, Jaguar's All-Wood Steering Wheel exudes the superior craftsmanship of your S-TYPE. Comprised entirely of Bird's Eye Maple and featuring raised thumb indicators, it can be ordered by color to match your vehicle's interior.

**Sable**                      **XR8 43100 AEK**  
**Charcoal**                      **XR8 43100 LEG**  
**Granite**                      **XR8 43100 LGP**



### **FRONT SHEEPSKIN SEAT COVERS**

Plush wool and ultrahigh-density fleece combine to provide a luxurious ride.

**XR8 52854**

### **WATERPROOF REAR SEAT COVERS**

These washable covers protect against spills and stains. Note: Doesn't allow use of split rear seat, armrest or ski hatch. (Not pictured.)

**C2C 10716**



### **UMBRELLA HOLDER**

Conveniently mounts under the trunk lid. (Not pictured.)

**C2C 5101**

### **SIDE WINDOW BLINDS**

Enhance the ride in your S-TYPE by limiting sunlight penetration.

**XR835539**

### **COLLAPSIBLE CARGO CARRIER**

Conveniently store objects — keeping items separate when necessary.

**C2C 28120**





**TRUNK HIGH-MOUNTED STORAGE**

This pull-out compartment maximizes trunk space while providing easy access to items.

**C2C 12192**

**TRUNK LID NET**

This net retains stored items while allowing easy access when the trunk is open. (Not pictured.)

**XR8 28874**

**TRUNK "HAMMOCK" NET**

Store items while retaining access to the rest of the trunk with this elastic net. (Not pictured.)

**XR8 2888**



**EXPANDABLE TRUNK CONTAINERS**

These pop-up bins conveniently hold groceries, picnic items, etc., and discreetly fold flat in your S-TYPE trunk floor when not in use.

**Kit with three bins**  
**Individual bins**

**XR8 34843**  
**XR8 34934**

**TRAVEL BAG**

Secured in the center of the rear seat, this bag provides storage and two soft drink holders. (Not pictured.)

**C2A 1244**

**TRUNK MAT**

Add extra protection for your trunk.

**JLM 21621**



**STORAGE NET**

Mount this compact, elastic net in your interior or trunk to hold a variety of items. (Not pictured.)

**C2A 1243**



### PREMIUM CARPET MATS

These plush, lambswool carpet mats with an embroidered Jaguar logo and leather-effect heel pad are sold in sets of four.

<b>Mocha</b>	<b>XR8 44197 AMB</b>
<b>Flint</b>	<b>XR8 44197 LFN</b>
<b>Granite</b>	<b>XR8 44197 LGP</b>

### CARPET MATS

Available in sets of four.

<b>Sable</b>	<b>XR8 49484 AEK</b>
<b>Flint</b>	<b>XR8 53917 LFN</b>
<b>Granite</b>	<b>XR8 49484 LGP</b>



### RUBBER FLOOR MATS

Maintain your S-TYPE's carpet with these comfortable, extra-thick mats. (Not pictured.)

<b>FRONT SET</b>	<b>XR8 52000</b>
<b>REAR SET</b>	<b>XR8 51998</b>

### LUGGAGE RETAINERS

Keep luggage or other rectangular items in place on your trunk floor. (Not pictured.)

**C2A 1054**

### TRUNK FLOOR LINER

This single-piece plastic liner features a slip-resistant texture. (Note: The liner must be removed to access the CD changer, if so equipped.)

**XR8 28882**



## SAFETY & CAR CARE

**DURING YOUR TRAVELS**, or as you maintain your vehicle, these Jaguar-approved accessories assist you in your ownership experience.



### **JAGUARWATCH**

Utilizing GPS technology, this vehicle recovery system can issue an automatic stolen vehicle alert and reveal your S-TYPE's exact location in 15-45 seconds. It also provides street-level maps, Internet tracking and call center support 24 hours a day, 365 days a year. Comes with a four-year warranty.

**AVAILABLE IN EARLY 2007**

### **WARNING TRIANGLE**

This reflective, two-tone marker alerts other drivers in the event you have to stop roadside. It conveniently stores in your luggage compartment when not in use and sets up in seconds for easy visibility, day or night.

**C2S 15716**

### **BULB KIT**

This collection of S-TYPE bulbs and fuses can help you address a range of challenges as they arise. The items conveniently stow in a durable case featuring the Jaguar logo.

**C2S 31481**

### **FLASHLIGHT**

Brighten your situation with this powerful flashlight that comes in a convenient case complete with batteries.

**JLM 2082**





## VEHICLE CARE PRODUCTS

Help maintain your S-TYPE's sterling appearance with the following products derived from Jaguar-approved formulas:

Alloy Wheel Cleaner	C2S 14564
Alloy Wheel Touch-Up Paint	C2A 1237
Anti-Mist Wipe	C2A 1027
Carpet Cleaning Kit	C2S1632
Cellulose Sponge	C2A 1026
Chamois (leather)	C2A 1025
De-Icer	C2A 1024
DVD/Navigation/Radio	
Screen Protector	C2A 1288
Fabric Cleaner	C2A 1062
Glass Cleaner	C2A 1023
Leather Cleaner	C2A 1061
Maintenance Spray — 200 ml	C2A 1022
Windshield Wash	C2A 1020
Shampoo	C2A 1016
Sponge	C2A 1068
Touch-Up Paint	
Adriatic Blue	C2A 1051 JJM
British Racing Green	C2S 1137 HGD
Ebony	C2A 1051 PEC
Jaguar Racing Green	C2A 1051 HGZ
Midnight	C2A 1051 PEF
Pacific Blue	C2S 1137 JHM
Platinum	C2S 1137 MDZ
Quartz	C2A 1051 LHK
Seafrost	C2S 1137 MDV
Topaz	C2S 1137 SEC
White Onyx	C2S 1137 NEG
Zircon	C2A 1051 JHV
Valet Kit (Exterior)	C2A 1029
Valet Kit (Interior)	C2A 1028
Wax	C2A 1017

# ENGINEERED FOR EXCELLENCE

ALL JAGUAR-APPROVED ACCESSORIES ARE RIGOROUSLY TESTED to the same exacting standards as our vehicles. They are examined under a range of temperatures, conditions and impacts to ensure durability and functionality worthy of Jaguar. Some of our testing categories include:

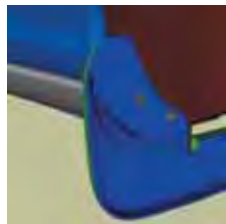

## PREDICTIVE ANALYSIS

Using the latest predictive stress analysis methods validates the safety and durability of Jaguar accessories.



## VIRTUAL ENGINEERING

Computer-Aided Design is used to ensure accessories are conceived to complement the vehicle's lines and stylish looks. This ensures the high quality of fit and finish that you have come to expect from Jaguar.



## ENVIRONMENTAL

Different climates provide different challenges for these parts. Jaguar accessories are tested under a range of climate conditions to ensure quality performance.

## DURABILITY

All accessories undergo the same test plan as the car itself, rigorously analyzed far beyond the extremes of normal customer usage.

## RIG TESTING

Heavily integrated parts, such as roof bars, are developed and tested very early on during vehicle development to ensure seamless compatibility.

# INDEX

ALLOY WHEELS	2-7	JAGUARWATCH	22
ARTEMIS	3	LICENSE PLATES & FRAMES	9
AURORA	2	LOCKING WHEEL NUTS	5
BARCELONA	4	LUGGAGE RETAINERS	21
HELIOS	3	LUGGAGE ROOF TRAY	11
HERAKLES	3	MESH GRILLES	8
INDIANAPOLIS	6	POWER FOLDING MIRRORS	12
JUNO	2	R PERFORMANCE EXHAUST SYSTEM	7
KRONOS	4	REAR SEAT CONNECTIVITY SYSTEM	14
MELBOURNE	2	REAR TRUNK LID SPOILER	8
MERCURY	4	ROOF BARS	10
MONACO	6	RUBBER FLOOR MATS	21
SPIRIT	3	SEAT COVERS	19
SPORTS	4	SIDE WINDOW BLINDS	19
TRITON	5	SIDE WINDOW DEFLECTORS	12
VALENCIA	2	SIRIUS SATELLITE RADIO	14
VULCAN	7	SKI/SNOWBOARD CARRIER	10
ZEUS	7	SNOW TRACTION CONTROL	5
AUDIO CONNECTIVITY MODULE	15	SPLASH GUARDS	13
BICYCLE CARRIERS	11	SPORT BOX	10
BLUETOOTH CONNECTIVITY MODULE	15	STEERING WHEELS	18
BULB KIT	22	STORAGE NET	20
CAR COVERS	13	SURFBOARD/KAYAK/ SAILBOARD CARRIER	11
CARPET MATS	21	TRAVEL BAG	20
CHROME MIRROR KIT	13	TRUNK FLOOR LINER	21
COLLAPSIBLE CARGO CARRIER	19	TRUNK HAMMOCK NET	20
EXHAUST FINISHERS	8	TRUNK HIGH-MOUNTED STORAGE	20
EXPANDABLE TRUNK CONTAINERS	20	TRUNK LID NET	20
FLASHLIGHT	22	TRUNK MAT	20
FOG LAMP COVERS	12	UMBRELLA HOLDER	19
FRONT HOOD PROTECTOR	11	VEHICLE CARE PRODUCTS	23
GEAR SHIFT KNOBS	16-17	VOICE ACTIVATION SYSTEM	15
HEADLAMP COVERS	12	WARNING TRIANGLE	22



JAGUAR CARS • Irvine, California, USA  
JAGUAR CANADA • Bramalea, Ontario, Canada  
JAGUAR MEXICO • Mexico City, Mexico

1-800-4-JAGUAR • [WWW.JAGUARUSA.COM](http://WWW.JAGUARUSA.COM)

IMPORTANT NOTICE: Accessories shown in this brochure are for current Model Year Jaguar S-TYPE cars except where noted. Jaguar constantly makes additions and deletions to the range of accessories offered to Jaguar owners. Accessory prices and availability are subject to change. For the latest information, consult with your authorized Jaguar dealer.

JAG S-TYPE

Printed in USA 12/2006

