

## JF506E (RE5F01A, 5F31J, JA5A-EL, 09A)

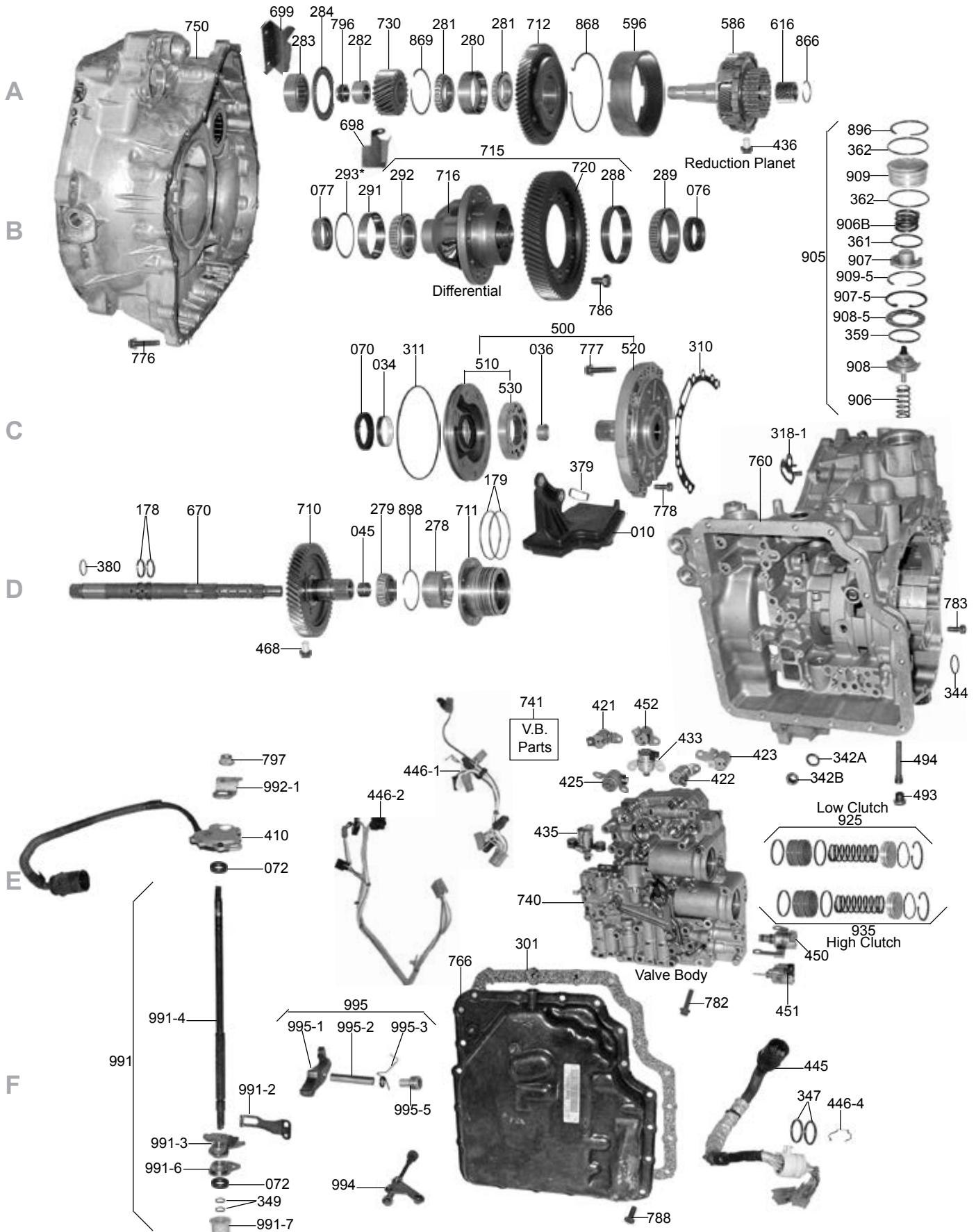

## JF506E (RE5F01A, 5F31J, JA5A-EL, 09A)

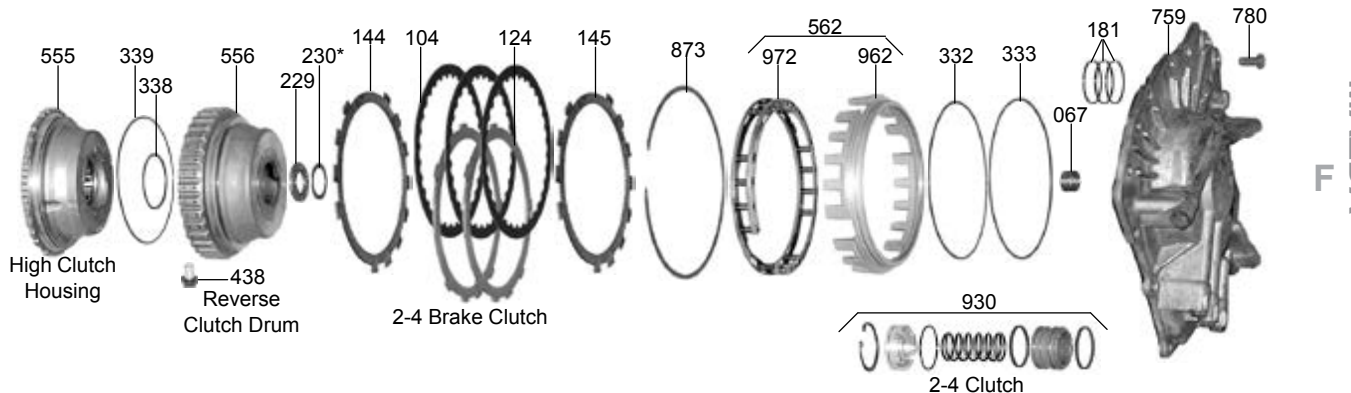
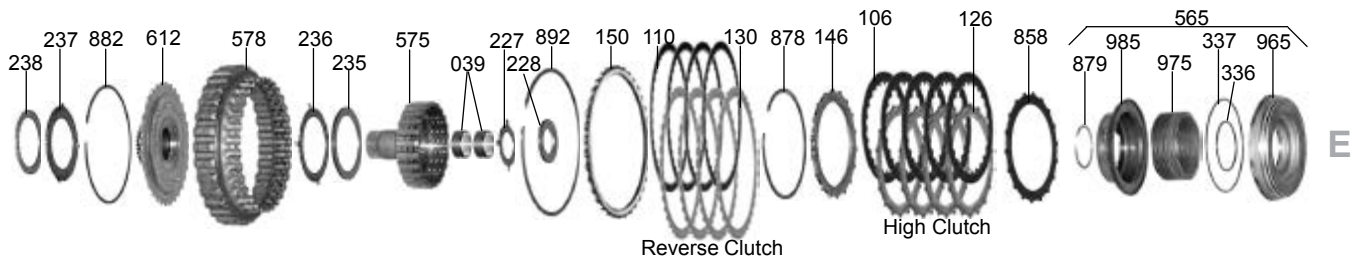
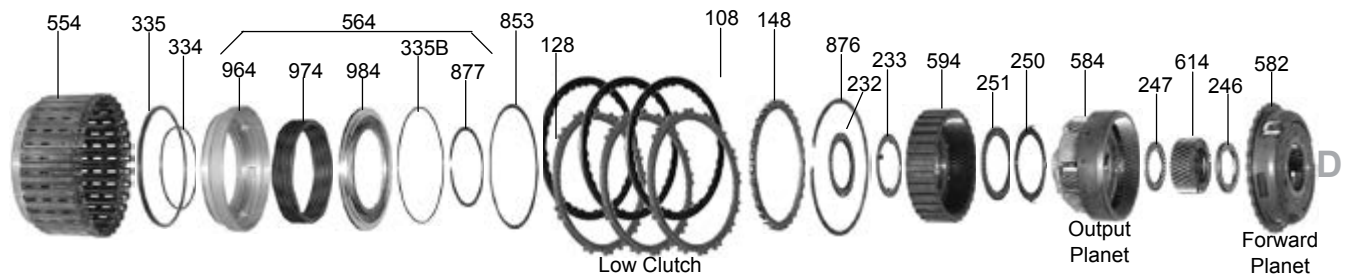
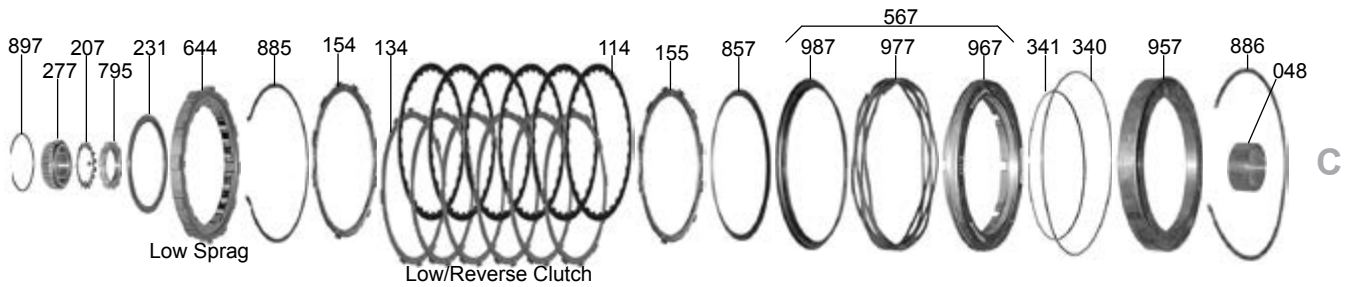
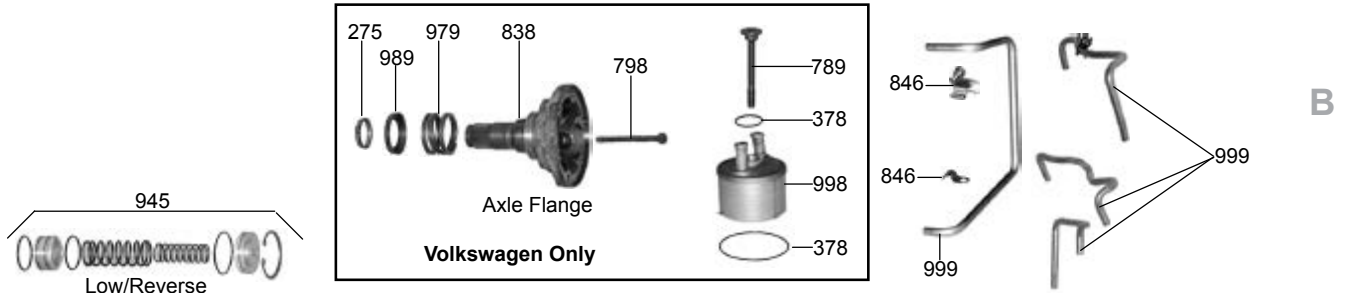
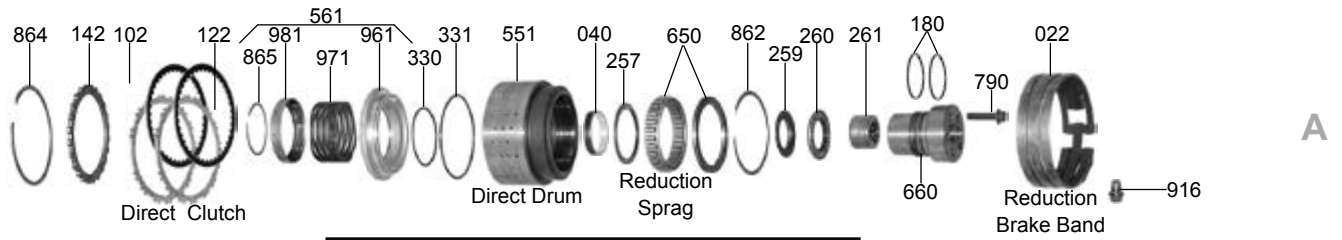

A

B

C

D

E

F

## JF506E (RE5F01A, 5F31J, JA5A-EL, 09A)

ILL#	Part#		QTY	REF#
<b>OVERHAUL KITS</b>				
NI.....	K122900.....	Overhaul Kit, JF506E (All) (W/Pistons) 2002-Up.....	1.....	N/A
<b>MASTER L/STEEL KITS</b>				
NI.....	DK12200S.....	Master L/Steels Kit, JF506E (All) (W/Pistons) 2002-Up.....	1.....	N/A
<b>MASTER W/STEELS KITS</b>				
NI.....	DK12200.....	Master W//Steels Kit, JF506E (All) (W/Pistons) 2002-Up.....	1.....	N/A
<b>FILTERS</b>				
010.....	122710.....	Filter, JF506E (Freelander, Mazda, Jaguar, Ford) (With Round Pick-Up) 2002-Up.....	1.....	TBA
010.....	122711.....	Filter, JF506E (VW Except VW Sharan) (.0650" Rectangle Pick-Up) 2002-Up.....	1.....	TBA
010.....	122712.....	Filter, JF506E (Land Rover VW Sharan) (1.300" Square Pick-Up) 2002-Up.....	1.....	TBA
<b>BANDS</b>				
022.....	122700.....	Band, JF506E (All) Reduction Brake (1.460" Wide) 2002-Up.....	1.....	FP01-19-360
<b>BUSHINGS</b>				
030.....	K122901.....	Bushing Kit, JF506E (All) 2002-Up.....	1.....	TBA
034.....	99005.....	Bushing, JF506E (All) Pump Body (1.760" OD)(1.645" ID) 2002-Up.....	1.....	TBA
036.....	122002.....	Bushing, JF506E (All) Stator (1.040" OD)(.925" ID) 2002-Up.....	1.....	TBA
039.....	122013.....	Bushing, JF506E (All) High Clutch Hub (.432" Tall) .885" OD (.790" ID) 2002-Up.....	2.....	TBA
040.....	122008.....	Bushing, JF506E (All) Direct Drum (.610" Wide) 1.990" OD (1.855" ID) 2002-Up.....	1.....	TBA
045.....	122021.....	Bushing, (All) Drive Transfer Gear (Rear) .985" OD (.865" ID) (Bronze) 2002-Up.....	1.....	TBA
048.....	122006.....	Bushing, (All) Low Clu Drum (3.135" OD) 3.070" ID (12 Holes) (Babbitt) 2002-Up.....	1.....	TBA
067.....	122024.....	Bushing, JF506E (All) Rear Cover (.745" OD, .625" ID) 2002-Up.....	1.....	TBA
<b>METAL CLAD SEALS</b>				
070.....	64151.....	Seal, JF506E (All) Front (2.335" OD) 2000-Up.....	1.....	63375
072.....	122155A.....	Seal, (All) Shift Lever, All Except Freelander (.975" OD, .560" ID) 2000-Up.....	1.....	62300
072.....	78197.....	Seal, JF506E (All) Shift Lever (Freelander) 2002-Up.....	1-2.....	48204
076.....	122152A.....	Seal, JF506E (Mazda) Axle (Both Sides) (2.207" OD, 1.550" ID) 2001-Up.....	2.....	58238
076.....	122152B.....	Seal, (Except Rover, Mazda) Axle (Both Sides) (2.830" OD, 2.270" ID) 2000-Up.....	2.....	58240
076.....	122152C.....	Seal, JF506E (Rover Except Freelander) Axle (Both Sides) 2000-Up.....	2.....	58075
076.....	122152D.....	Seal, JF506E (Freelander) Axle (Both Sides) 2000-Up.....	2.....	58033
076.....	122152B.....	Seal, JF506E, Jaguar (2wd) Axle (Case Side) (With Flange) 2000-Up.....	1.....	58240
077.....	122152B.....	Seal, JF506E, Jaguar (2wd) Axle (Bell Housing Side) 2000-Up.....	1.....	58240
NI.....	122160A.....	Seal, JF506E, Output (AWD) Jaguar 2000-Up.....	1.....	58360
NI.....	122160B.....	Seal, Transfer Case, JF506E, Rear Output 2000-Up.....	1.....	58875
NI.....	122160C.....	Seal, Transfer Case, JF506E, Side Output 2000-Up.....	1.....	58506
<b>FRICTIONS</b>				
102.....	122101.....	Friction, JF506E (All) Direct Clutch (.069") 24 Teeth (4" OD) 2002-Up.....	3-4.....	TBA
104.....	122104.....	Friction, JF506E (All) 2-4 Brake Clutch (.063") 32 Teeth (7 1/2" OD) 2002-Up.....	3.....	TBA
106.....	63100A.....	Friction, JF506E (All) High Clutch (.063") 24 Teeth (4.400" OD) 2002-Up.....	5.....	TBA
108.....	69102A.....	Friction, JF506E (All) Low Clutch (.070") 30 Teeth (5 7/16" OD) 2002-Up.....	6-7.....	TBA
110.....	122105.....	Friction, JF506E (All) Reverse Clutch (.063") 32 Teeth (6 1/8" OD) 2002-Up.....	2.....	TBA
114.....	63102.....	Friction, JF506E (All) Low/Reverse Clutch (.071") 32 Teeth (6.500" OD) 2002-Up.....	5-6.....	TBA
119.....	RK122F.....	Friction Module, JF506E (All) 2002-Up.....	1.....	TBA
<b>STEELS</b>				
122.....	122111.....	Steel, JF506E (All) Direct Clutch (.079") 24 Teeth (3 3/8" ID) 2002-Up.....	4-5.....	TBA
124.....	122114.....	Steel, JF506E (All) 2-4 Brake Clutch (.118") 7 Teeth (6 5/8" OD) 2002-Up.....	2.....	TBA
126.....	122116.....	Steel, JF506E (All) High Clutch (.095") 18 Teeth (3.608" ID) 2002-Up.....	4.....	TBA
126.....	122117.....	Steel, JF506E (All) High Clutch (.062") 18 Teeth (3.608" ID) 2002-Up.....	4.....	TBA
128.....	122113.....	Steel, JF506E (All) Low Clutch (.055") 32 Teeth (4.845" ID) 2002-Up.....	6-7.....	TBA
130.....	122115.....	Steel, JF506E (All) Reverse Clutch (.079") 36 Teeth (5 5/8" OD) 2002-Up.....	2.....	TBA
134.....	122112.....	Steel, JF506E (All) Low/Reverse Clutch (.055") 10 Teeth (5.910" ID) 2002-Up.....	5-6.....	TBA
139.....	K122S.....	Steel Module, JF506E (All) 2002-Up.....	1.....	TBA
<b>PRESSURE PLATES</b>				
142.....	122718A.....	Press Plate, JF506E (Freelander/VW) Dir Cl (Top) .163" (24T) 3.385" ID, 2002-Up.....	1.....	TBA
142.....	122718AA.....	Pressure Plate, (Mazda) Direct Clutch (Top) .171" (24 Teeth) (3.385" ID) 2002-Up.....	1.....	TBA
142.....	122718AB.....	Pressure Plate, (Jaguar) Direct Clutch (Top) .178" (24 Teeth) (3.385" ID) 2002-Up.....	1.....	TBA
144.....	122721AA.....	Press Plate, JF506E (All) 2-4 Brake Clutch #144 2002-Up.....	1.....	TBA
145.....	122721A.....	Apply Plate, JF506E (Freelander/VW) 2-4 Brake Cl (.140") 7T (6 5/8" ID) 2002-Up.....	1.....	TBA
145.....	122721AA.....	Apply Plate, JF506E (Freelander/VW) 2-4 Brake Clutch (.163") 7 Teeth (6 5/8" ID).....	1.....	TBA
145.....	122721AB.....	Apply Plate, (Mazda/Jaguar) 2-4 Brake Clutch (.298") 7 Teeth (6 5/8" ID) 2002-Up.....	1.....	TBA

## JF506E (RE5F01A, 5F31J, JA5A-EL, 09A)

ILL#	Part#		QTY	REF#
145.....	122721AC	Apply Plate, (Mazda/Jaguar) 2-4 Brake Clutch (.308") 7 Teeth (6 5/8" ID) 2002-Up	1	TBA
146.....	122715A	Pressure Plate, JF506E (All) High Clutch (.118") 18 Teeth (3.610" ID) 2002-Up	1	TBA
146.....	122715AA	Pressure Plate, JF506E (All) High Clutch (.126") 18 Teeth (3.610" ID) 2002-Up	1	TBA
146.....	122715AB	Pressure Plate, JF506E (All) High Clutch (.134") 18 Teeth (3.610" ID) 2002-Up	1	TBA
146.....	122715AC	Pressure Plate, JF506E (All) High Clutch (.142") 18 Teeth (3.610" ID) 2002-Up	1	TBA
148.....	122720A	Press Plate, JF506E (Freelander/VW/Mazda) Low Cl (.170") 32T, 4.845" ID, 02-Up	1	TBA
148.....	122135AA	Pressure Plate, JF506E (Jaguar) Low Clutch (.160") 32 Teeth (4.845" ID) 2002-Up	1	TBA
150.....	122135	Pressure Plate, JF506E (All) Reverse Clutch (.141") 36 Teeth (5.615" ID) 2002-Up	1	TBA
150.....	122135A	Pressure Plate, JF506E (All) Reverse Clutch (.150") 36 Teeth (5.615" ID) 2002-Up	1	TBA
150.....	122135B	Pressure Plate, JF506E (All) Reverse Clutch (.157") 36 Teeth (5.615" ID) 2002-Up	1	TBA
150.....	122135C	Pressure Plate, JF506E (All) Reverse Clutch (.165") 36 Teeth (5.615" ID) 2002-Up	1	TBA
154.....	122720AA	Press Plate, (Freelander/Jaguar/VW) Low/Rev Cl (Top) 10T, .148" Thk, Stepped, 02-	1	TBA
154.....	122720AB	Press Plate, (Mazda) Low/Rev Cl (Top) 10 Teeth (.250" Thk) Stepped, 2002-Up	1	TBA
155.....	122720AC	Apply Plate, (Freeland/Jag/Maz) Low/Rev Cl (.092" Thk) 10T, 5.910" ID, Flat 2002-Up	1	TBA
155.....	122720AD	Apply Plate, JF506E (VW) Low/Rev Cl (.100" Thick) 10T (5.910" ID) Flat, 2002-Up	1	TBA
<b>SEALING RINGS</b>				
175.....	K122903	Ring Kit, JF506E, 2002-Up	1	TBA
179.....	122301	Ring, JF506E (All) Input Shaft (1.040" OD) (Teflon) 2002-Up	1	TBA
178.....	122302	Ring, JF506E (All) Low Clutch (3.065" OD) (Vespel) 2002-Up (Lap Joint)	2	TBA
180.....	122303	Ring, (All) Dir Cl (On Supp #660) .090" Thk (2.050" OD) Lap Joint, Vespel 2002-Up	1	TBA
181.....	122304	Ring, (All) Reverse Clutch (In Rear Cover) 1.750" OD (V Joint) Teflon 2002-Up	3	TBA
<b>WASHERS &amp; BEARINGS</b>				
207.....	122401A	Lock Washer, JF506E (All) Sits Under Nut #795 2002-Up	1	TBA
227.....	122441A	Race, JF506E (All) High Cl Hub To Rev Cl Hsg (4 Tab) (.032" Thk, 1.775" OD, 1.08" ID)	1	TBA
228.....	122415A	Brg W/Race, JF506E (All) High Cl Hub To Rev Cl Hsg (.132" Thk, 1.81" OD, 1.01" ID)	1	TBA
229.....	122416A	Brg W/Race, JF506E (All) Rev Cl Drum To Rear Cover (1.40" Thk, 1.725" OD, .910" ID)	1	TBA
230.....	122442A	Race, JF506E (All) Rev Cl Drum To Rear Cover (Select) 1.660" OD, .982" ID, 2002-Up	1	TBA
231.....	122417A	Bearing W/Race, JF506E (All) Support To Low Drum (.158" Thick) 4.355" OD (3.765" ID)	1	TBA
232.....	122418A	Brg W/Race, JF506E (All) Supp To Output Ring Gr (.110" Thk) 2.830" OD, 1.965" ID	1	TBA
233.....	122443A	Race, (All) Support To Output Ring Gear (.032" Thick) 2.740" OD (4 Tab) 2002-Up	1	TBA
235.....	122422A	Use 122422A	1	TBA
236.....	122444A	Race, (All) Fwd Sun Gear Hub To High Cl Hub (4 Tab) .032" Thk, 3.15" OD, 2.36" ID	1	TBA
237.....	122445A	Race, (All) Fwd Planet To Fwd Sun Gear Hub (4 Tab) .032" Thk, 3.15" OD, 2.073" ID	1	TBA
238.....	122419A	Brg W/Race, (All) Fwd Planet To Fwd Sun Gr Hub (.110" Thk, 2.75" OD, 2.055" ID)	1	TBA
246.....	122420A	Brg W/Races, (All) Output Sun Gr To Fwd Planet (.190" Thick, 2.08" OD, 1.39" ID)	1	TBA
247.....	122421A	Brg W/Race, (All) Output Planet To Output Sun Gr (.133" Thk, 2.080" OD, 1.345" ID)	1	TBA
250.....	122446A	Race, (Freeland) Output Ring Gr To Output Planet (4 Tab) .048", 2.95" OD, 2.315" ID	1	TBA
250.....	122446B	Race, (Maz/Jag/VW) Output Ring Gear To Output Planet (3 Tab) .048", 2.95", 2.315"	1	TBA
251.....	122422A	Brg W/Race, JF506E (All) Output Ring Gear To Output Planet (.110" Thk) 3.065" OD, (2.295" ID) (Also JF506E (All) Forward Planet Sun Gear Hub To High Cl Hub #235)	2	TBA
257.....	122423A	Bearing W/Races, (All) Direct Drum To Support (.123" Thick) 2.592" OD (2.010" ID)	1	TBA
259.....	122447A	Race, JF506E (Freelander) Reduction Sun Gr To Dir Drum Supp (.071" Thk, .829" ID)	1	TBA
259.....	122447B	Race, JF506E (Mazda) Reduction Sun Gear To Dir Drum Supp (.040" Thick) .912" ID	1	TBA
259.....	122447C	Race, JF506E (Jag/VW) Reduction Sun Gr To Dir Drum Supp (.071" Thk, .912" ID)	1	TBA
260.....	122424A	Brg W/Race, (Freeland/Jag/VW) Red Sun Gr To Dir Drum Supp (.117" Thk, .83" ID)	1	TBA
260.....	122424B	Brg W/Race, (Mazda) Red Sun Gr To Dir Drum Supp (.150" Thk, .83" ID) 2002-Up	1	TBA
261.....	122425A	Caged Needle Bearing, JF506E (All) Inside Direct Drum Support (11 Needles) Cast # NSK TORR VP1Z-1 (1.385" OD) 2002-Up (Sold With 183660A Support)	1	TBA
275.....	122402A	Washer, (VW) Axle Flange To Diff (Split, Brass) (.250" Thk) W/ 6 Notches On OD	1	TBA
277.....	122977A	Use 122977A	1	TBA
278.....	122978A	Cup Race, JF506E (All) Supp To Cone Bearings (Double Tapered) 1.10" Thk, 2.285" OD	1	TBA
279.....	122977A	Cone Bearing, JF506E (All) Drive Transfer Gear To Supp (HFT AR35-18G, NSK TC7JP)	2	TBA
280.....	122978B	Double Cup Race, (All) Sits In Driven Transfer Gear (.865" Thick, 2.835" OD) 2002-Up	1	TBA
281.....	122977B	Cone Bearing, JF506E (All) Driven Transfer Gear To Reduction Planet Shaft (Cast # AR35-20G HTF NSK) 25 Rollers (1.377" ID) 2002-Up	2	TBA
282.....	122448A	Inner Race, JF506E (All) Under Nut On Reduction Planet Shaft (Cast # HTF P25-43G)	1	TBA
283.....	122426A	Caged Roller Brg, (Freelander) Bell Hsg To Reduct Planet Shaft, 16 Roller, 2.445" OD	1	TBA
283.....	122426B	Caged Roller Bearing, JF506E (Mazda/Jaguar/Volkswagen) Bell Housing To Reduction Planet Shaft (16 Rollers) 2.755" OD (With 2 Flats On The Back Side) 2002-Up	1	TBA
284.....	122427A	Bearing W/Race, JF506E (Freelander/Jaguar) Pinion Gear To Roller Bearing #283	1	TBA
284.....	122427B	Bearing W/Race, JF506E (Mazda) Pinion Gear To Roller Bearing #283 (.131" Thick)	1	TBA
284.....	122427C	Bearing W/Race, JF506E (Volkswagen) Pinion Gear To Roller Bearing #283 (.161" Thick)	1	TBA
288.....	122978C	Cup Race, JF506E (Freelan/VW) Diff Hsg To Case (Cast # NSK HR32914J) (3.940" OD)	1	TBA
288.....	122978CA	Cup Race, JF506E (Mazda/Jag) Diff Hsg To Case (Cast # KOYO 32913JR) 3.545" OD	1	TBA
289.....	122977C	Cone Brg, JF506E (Freelan/VW) Diff Hsg To Case (31 Rollers)(Cast # NSK HR32914J)	1	TBA
289.....	122977CA	Cone Brg, JF506E (Maz/Jag) Diff Hsg To Case (35 Rollers)(Cast # KOYO 32913JR)	1	TBA

## JF506E (RE5F01A, 5F31J, JA5A-EL, 09A)

ILL#	Part#		QTY	REF#
291.....	122978D.....	Cup Race, (Freelan/VW) Diff Hsg To Bell Hsg (Cast # NSK HR32010XJ) (3.150" OD).....	1.....	TBA
291.....	122978DA.....	Cup Race, JF506E (Maz/Jag) Diff Hsg To Bell Hsg (Cast # KOYO STC6088) (3.465" OD).....	1.....	TBA
292.....	122977D.....	Cone Brg, (Freelan/VW) Diff Hsg To Bell Hsg (# NSK HR32010XJA3) (24 Roller).....	1.....	TBA
292.....	122977DA.....	Cone Brg, (Maz/Jag) Diff Hsg To Bell Hsg (#KOYO STV6088) (29 Rollers) (2.363" ID).....	1.....	TBA
293.....	122449A.....	Shim, JF506E (Freelan/VW) Diff Brg Race To Bell Hsg Selective) (3.140" OD) (2.735" ID).....	1.....	TBA
293.....	122449B.....	Shim, JF506E (Maz/Jag) Diff Brg Race To Bell Hsg, Selective (3.460" OD) (3.845" ID).....	1.....	TBA

### GASKETS & RUBBER COMPONENTS

301.....	122507.....	Gasket, JF506E (All) Side Pan 2002-Up.....	1.....	TBA
301.....	122507F.....	Gasket, JF506E (All) Side Pan (Farpak) 2002-Up.....	1.....	TBA
307.....	122524.....	Gasket, JF506E (Volkswagen) Servo Cover (3 Bolt) 2002-Up.....	1.....	TBA
310.....	122276.....	Gasket, JF506E (All) Pump Stator To Case 2002-Up.....	1.....	TBA
311.....	123516A.....	O-Ring, JF506E (All) Pump Body 2002-Up.....	1.....	TBA
320.....	122512A.....	Gasket, JF506E, Valve Body Upper & Lower, All Except Mazda, 1999-Up.....	2.....	TBA
320.....	122521B.....	Gasket, JF506E, Valve Body Upper & Lower, Mazda, 2001-Up.....	2.....	TBA
NI.....	122529A.....	Gasket, JF506E, Auxiliary Valve Body Upper & Lower, All, 1999-Up.....	2.....	TBA
380.....	122511.....	O-Ring, JF506E (All) Input Shaft (Front) To Converter 2002-Up.....	1.....	TBA

### TECHNICAL MANUALS

400.....	TMJF506E.....	Tech Manual, Jatco 5 Speed FWD Rebuild Procedures.....	1.....	TBA
400.....	TMJF506EUP.....	Tech Manual, JF506E Update Handbook (Identifies Differences In Makes & Models).....	1.....	TBA

### ELECTRICAL COMPONENTS

410.....	122991A.....	PRNDL Switch, JF506E (Freelander) 5 Wire (21 1/2" Long Wire Harness) 2002-Up.....	1.....	TBA
410.....	122991B.....	PRNDL Switch, JF506E (Mazda) 7 Wire (17" Long Wire Harness) 2002-Up.....	1.....	TBA
410.....	122991C.....	PRNDL Switch, JF506E (Jaguar) 9 Wire (16" Long Wire Harness) 2002-Up.....	1.....	TBA
445.....	122986A.....	Wire Harness, JF506E (Freelander) External (26 1/2" Long) (18 Wire White Pass Through.....	1.....	TBA
.....	.....	Connector, With 1 Ten Prong And 1 Eight Prong Square Connector) 2002-Up.....	.....	.....
445.....	122986B.....	Wire Harness, JF506E (Mazda) External (17 1/2" Long) (18 Wire White Pass Through.....	1.....	TBA
.....	.....	Connector, With 2 Ten Prong And 2 Eight Prong Square Connectors) 2002-Up.....	.....	.....
445.....	122986C.....	Wire Harness, JF506E (VW) External (5 1/2" Long) (20 Wire Black Pass Through.....	1.....	TBA
.....	.....	Connector, With 2 Ten Prong And 1 Eight Prong Square Connectors) 2002-Up.....	.....	.....
445.....	122986D.....	Wire Harness, JF506E (Jaguar) External (20" Long) (18 Wire White Pass Through Conn,.....	1.....	TBA
.....	.....	With 1 Eighteen Prong Connector) 2002-Up.....	.....	.....
446.....	122988A.....	Solenoid Wire Harness, JF506E (Freelander/Jaguar/VW) (Internal) (10 Prong.....	1.....	TBA
.....	.....	Connector With 9 One Blade Connector And A Ground) 2002-Up.....	.....	.....
446.....	122988B.....	Wire Harness, JF506E (Jaguar/Freelander/Mazda) (Internal) (8 Prong Yellow Conn With.....	1.....	TBA
.....	.....	Three 2-Blade Connector And With Temperature Sensor) 2002-Up.....	.....	.....
446.....	122986CL.....	Clip, JF506E (All) Holds Wire Harness Connector To Case.....	1.....	TBA
446.....	122988C.....	Solenoid Wire Harness, JF506E (Mazda) (Internal) (10 Prong Conn With 7 One Blade.....	1.....	TBA
.....	.....	Connector And 2 Two Prong Connectors And A Ground) 2002-Up.....	.....	.....
446.....	122988D.....	Wire Harness, JF506E (Volkswagen) (Internal) (8 Prong Red Conne With 3 Two Blade.....	1.....	TBA
.....	.....	Connectors And A Temperature Sensor) 2002-Up.....	.....	.....

### SOLENOIDS & SENSORS - MAZDA

420.....	122991.....	Solenoid Kit, JF506E (Mazda) (9 Solenoids) 1999-Up.....	1.....	TBA
421.....	122925A.....	Shift "A", Brown, # On Bottom Of Sol - G6T-44275.....	1.....	31941-PM004
422.....	122926A.....	Shift "B", Brown, # On Bottom Of Sol - G6T-44273.....	1.....	31941-PR000
423.....	122927B.....	Shift "C", Green, # On Bottom Of Sol - G6T-44276.....	1.....	31941-PM003
425.....	122929A.....	L/Up / EPC Duty, Black, No # On Bottom Of Sol (3-Distinct Legs).....	1.....	31941-PM000
433.....	122928B.....	High Clutch Duty & 2-4 Duty, Black, # On Bottom Of Sol - G6T-46176.....	2.....	31941-PM001
435.....	122946A.....	PL(Line Pressure) Duty, Green, # On Bottom Of Sol - G6T-46174.....	1.....	31941-PR015
451.....	122921B.....	Neutral Shift, Black, # On Bottom Of Sol - G6T-46278.....	1.....	31941-PM005
452.....	122920A.....	Reduction Timing, White, # On Bottom Of Sol - G6T-46277.....	1.....	31941-PM002
436.....	122958A.....	Sensor, Output, Input And Intermediate.....	3.....	31935-PW000

### SOLENOIDS & SENSORS - JAGUAR / VW / LANDROVER

420.....	122990.....	Solenoid Kit, JF506E (Freelander, Jaguar, VW) (9 Solenoids) 1999-Up.....	1.....	TBA
421.....	122925.....	Shift "A", Brown, # On Bottom Of Sol - G6T-46273.....	1.....	31941-PR006
422.....	122926A.....	Shift "B", Brown, # On Bottom Of Sol - G6T-44273.....	1.....	31941-PR000
423.....	122927A.....	Shift "C", Green, # On Bottom Of Sol - G6T-46272.....	1.....	31941-PR005
425.....	122929.....	L/Up / EPC Duty, Black, No # On Bottom Of Sol.....	1.....	31941-PR010
433.....	122928A.....	2-4 Duty, White, # On Bottom Of Sol - G6T-46172.....	1.....	31941-PR011
433.....	122930.....	Low Clutch, Black, # On Bottom Of Sol - G6T-46274.....	1.....	31941-PR007
435.....	122946A.....	PL Duty (Line Pressure), Green, # On Bottom Of Sol - G6T-46174.....	1.....	31941-PR015
450.....	122923A.....	2-4 Brake Timing - Duty, Black, # On Bottom Of Sol - G6T-46275.....	1.....	31941-PR008
452.....	122920.....	Reduction Timing, White, # On Bottom Of Sol - G6T-46276.....	1.....	31941-PR014
436.....	122958A.....	Sensor, Output, Input And Intermediate.....	3.....	31935-PW000

## JF506E (RE5F01A, 5F31J, JA5A-EL, 09A)

ILL#	Part#		QTY	REF#
<b>MISCELLANEOUS COMPONENTS</b>				
493.....	122493.....	Plug, JF506E (Freelander/Volkswagen) Fluid Check (5mm Allen Head) 2002-Up .....	1.....	TBA
493.....	122493A.....	Plug, (Maz/Jag) Fluid Check (14mm Hex Head) (Also For Pressure Tap Plugs .....	1.....	TBA
494.....	122494.....	Fluid Level Tube, (Freelander/Mazda/Jaguar) (5mm Allen Head, 2" Long) 2002-Up .....	1.....	TBA
494.....	122494A.....	Fluid Level Tube, JF506E (Volkswagen) (5mm Allen Head, 3/4" Long) 2002-Up .....	1.....	TBA
<b>PUMPS &amp; PUMP COMPONENTS</b>				
500.....	122200A.....	Pump, JF506E, 32 Spline Alum Stator, Cast Iron Body W/2 Flats On Inner Gear .....	1.....	TBA
510.....	122201A.....	Body W/Gears, (All) Pump (8 Bolt) (Cast Iron) 2002-Up (With 2 Flats On Inner Gear).....	1.....	TBA
520.....	122202A.....	Stator, JF506E (All) (Aluminum) (7 Bolts To Case) (32 Splines) 2002-Up.....	1.....	TBA
530.....	K122201A.....	Gear Set, JF506E Pump (.524" Thick) (9 Teeth Inner Gear With 2 Flats) 2002-Up .....	1.....	TBA
<b>DRUMS &amp; CLUTCH HUBS</b>				
551.....	122732A.....	Drum, JF506E (Freelander) Direct Clutch (With 23 Sun Gear Splines) 2002-Up .....	1.....	TBA
551.....	122732B.....	Drum, JF506E (Maz/Jag) Dir Cl (W/ 31 Sun Gr Splines) (.340" Inside Bottom Wall Height).....	1.....	TBA
551.....	122732C.....	Drum, JF506E (VW) Dir Cl (31 Sun Gr Splines) (.410" Inside Bottom Wall Height) 2002-Up .....	1.....	TBA
554.....	122733A.....	Drum, JF506E (All) Low Clutch (6 or 7 Clutch) (32 Teeth Steels) 2002-Up.....	1.....	TBA
555.....	122734A.....	Housing, JF506E (All) High Cl (Aluminum) (2.115" Thk) (2.050" ID) (1st Design) 2002-Up .....	1.....	TBA
555.....	122734B.....	Housing W/ Out Piston, JF506E (All) High Cl (Aluminum) (2nd Design).....	1.....	TBA
555.....	122734C.....	Housing & Piston, JF506E (All) High Cl (Alum) (2.115" Thk)(2.050" ID) (2nd Design).....	1.....	TBA
556.....	122735A.....	Drum, (All) Rev Cl (Stamped Steel) (36T Steels) (2.875" Tall, 1.766" ID Bore, 2002-Up .....	1.....	TBA
561.....	K122762A.....	Piston Kit, JF506E (Freelan/Maz/Jag) Dir Cl (.330" Thk At The Edge Of Piston) 2002-Up .....	1.....	TBA
561.....	K122762B.....	Piston Kit, JF506E (VW) Direct Cl (.270" Thk At Edge Of The Piston) 2002-Up .....	1.....	TBA
562.....	K122763A.....	Piston Kit, JF506E (All) 2-4 Brake Clutch (Aluminum Piston) 2002-Up.....	1.....	TBA
564.....	K122764A.....	Piston Kit, JF506E (Freelan/VW/Mazda) Low Clu (1.260" Thick Piston) 2002-Up .....	1.....	TBA
564.....	K122764B.....	Piston Kit, JF506E (Jaguar) Low Clutch (1.390" Thick Piston) 2002-Up.....	1.....	TBA
565.....	K122765A.....	Piston Kit, JF506E (All) High Clutch (Aluminum Piston) (With Bonded Retainer) 2002-Up .....	1.....	TBA
567.....	K122766A.....	Piston Kit, JF506E (Freelander) Low/Reverse Clutch (.905" Thick Piston) 2002-Up .....	1.....	TBA
567.....	K122766B.....	Piston Kit, JF506E (Mazda) Low/Reverse Clutch (.805" Thick Piston) 2002-Up .....	1.....	TBA
567.....	K122766C.....	Piston Kit, JF506E (Volkswagen) Low/Reverse Clutch (.780" Thick Piston) 2002-Up .....	1.....	TBA
567.....	K122766D.....	Piston Kit, JF506E (Jaguar) Low/Reverse Clutch (1.040" Thick Piston) 2002-Up.....	1.....	TBA
575.....	122740A.....	Clutch Hub, JF506E (All) High Clutch (24 Teeth) (2.815" Tall) 2002-Up.....	1.....	TBA
578.....	122741A.....	Clutch Hub, JF506E (All) 2nd Brake And Reverse Clutch (32 Teeth/32 Teeth) 2002-Up .....	1.....	TBA
<b>PLANETS, RING GEARS &amp; SUN GEARS</b>				
582.....	122747A.....	Planet, JF506E (Freelander) Forward (3 Gear) (34 Teeth Sun Gear) 2002-Up .....	1.....	TBA
582.....	122747B.....	Planet, JF506E (Mazda/Jag/VW) Forward (4 Gear) (34 Teeth Sun Gear) 2002-Up .....	1.....	TBA
584.....	122748A.....	Planet, JF506E (Freelander) Output (4 Gear) (42T Sun Gear) (74T Ring Gear) 2002-Up .....	1.....	TBA
584.....	122748B.....	Planet, JF506E (Maz/Jag/VW) Output (5 Gear) (42T Sun Gear) (74T Ring Gear) 2002-Up .....	1.....	TBA
584.....	K122748.....	Geartrain, JF506E (Includes: iLL# 594 To iLL# 575).....	1.....	TBA
586.....	122749A.....	Planet, JF506E (Freelander) Reduction W/Shaft (23T Sun Gr) (No Groove, 18 Park Lugs).....	1.....	TBA
586.....	122749B.....	Planet, JF506E (Maz/Jag) Reduction W/Shaft (31T Sun Gr) (2 Groove, 18 Park Lugs).....	1.....	TBA
586.....	122749C.....	Planet, JF506E (VW) Reduction W/Shaft (31T Sun Gear) (1 Groove, 18 Park Lugs).....	1.....	TBA
594.....	122758A.....	Ring Gear, JF506E (All) Output Planet (75 Teeth) 2002-Up.....	1.....	TBA
596.....	122759A.....	Ring Gear, JF506E (Freelander) Reduction Planet (93T) 2 Notches (5.565" OD) 2002-Up .....	1.....	TBA
596.....	122759B.....	Ring Gear, JF506E (Maz/Jag/VW) Reduction Planet (85T) (5.435" OD) 2002-Up .....	1.....	TBA
612.....	122753A.....	Sun Gear W/Hub, JF506E (All) Forward Planet (34 Teeth) (32 Outer Lugs) 2002-Up .....	1.....	TBA
614.....	122755A.....	Sun Gear, JF506E (All) Output Planet (42T) (20 Splines) (.910" Thk) (2.335" OD) 2002-Up .....	1.....	TBA
616.....	122756A.....	Sun Gear, JF506E (Freelander) Reduction Planet (32T, No Groove) (1.275" Thick) .....	1.....	TBA
616.....	122756B.....	Sun Gear, JF506E (Mazda/Jaguar) Reduction Planet (31 Teeth, 2 Groove) 2002-Up .....	1.....	TBA
616.....	122756C.....	Sun Gear, JF506E (VW) Reduction Planet (31T, 1 Groove) (1.255" Thick) 2002-Up.....	1.....	TBA
<b>SPRAGS &amp; ONE WAY CLUTCHES</b>				
644.....	122727A.....	Sprag, JF506E (All) Low (18 Rollers) 12 Teeth (.515" Thick) 2002-Up .....	1.....	TBA
650.....	122725A.....	Sprag, JF506E (All) Reduction (28 Elements) (.632" Thick) 2002-Up.....	1.....	TBA
<b>SHAFTS, GEARS &amp; DIFFERENTIALS</b>				
660.....	122825A.....	Support, (All) Direct Drum (2.875" Tall) (1.850" OD At Bushing Surface) 2002-Up .....	1.....	TBA
670.....	122851A.....	Shaft, JF506E (Freelander/VW) Input (12 1/2" Long) 20 Splines (2 Rings) 2002-Up .....	1.....	TBA
670.....	122851B.....	Shaft, JF506E (Mazda/Jaguar) Input (12 1/2" Long) 20 Splines (3 Rings) 2002-Up .....	1.....	TBA
698.....	122698.....	Oil Deflector, JF506E (Freelander) 2 Bolt 2002-Up.....	1.....	TBA
698.....	122698A.....	Oil Deflector, JF506E (Mazda) 2 Bolt 2002-Up .....	1.....	TBA
698.....	122698B.....	Oil Deflector, JF506E (Volkswagen) 2 Bolt 2002-Up .....	1.....	TBA
698.....	122698C.....	Oil Deflector, JF506E (Jaguar) 2 Bolt 2002-Up .....	1.....	TBA
699.....	122699.....	Oil Baffle, JF506E (Freelander) For #712 (2 Bolt) (5 1/2" Long) 2002-Up .....	1.....	TBA
699.....	122699A.....	Oil Baffle, JF506E (Mazda) For #712 (2 Bolt) (4 1/2" Long) 2002-Up .....	1.....	TBA
699.....	122699B.....	Oil Baffle, JF506E (Jaguar) For #712 (2 Bolt) (4 7/8" Long) 2002-Up .....	1.....	TBA
710.....	122810A.....	Gear, JF506E (Freelan) Drive Transfer (54T) 5.920" OD (Fits 2 Ring Input Shaft) .985" ID .....	1.....	TBA

## JF506E (RE5F01A, 5F31J, JA5A-EL, 09A)

ILL#	Part#		QTY	REF#
710	122810AA	Gear, (Jag) Drive Transfer (54T) 5.920" OD (Fits 3 Ring Input Shaft(1.05" Ring Bore) .....	1	TBA
710	122810B	Gear, (Maz) Drive Transfer (41T) 6.085" OD (Fits 3 Ring Input Shaft(1.05" Ring Bore) .....	1	TBA
710	122810C	Gear, (VW) Drive Transfer (52T) 5.770" OD (Fits 2 Ring Input Shaft(.985" Ring Bore) .....	1	TBA
711	122870A	Support, JF506E (Freelan/Jag/Maz) Drive Transfer Gear (4 Notches Inside, 1 Snap Ring .....	1	TBA
711	122870B	Support, JF506E (VW) Drive Transfer Gear (No Notches Inside, Uses 2 Snap Rings .....	1	TBA
712	122811A	Gear, JF506E (Freelander) Driven Transfer (65 Teeth No Groove) (With Ring Gear Hub) .....	1	TBA
712	122811B	Gear, JF506E (Mazda) Driven Transfer (47T, 1 Groove) (With Ring Gear Hub) 2002-Up .....	1	TBA
712	122811C	Gear, JF506E (Volkswagen) Driven Transfer (67 Teeth, 1 Groove) (With Ring Gear Hub) .....	1	TBA
712	122811D	Gear, JF506E (Jaguar) Driven Transfer (65T, 2 Groove) (With Ring Gear Hub) 2002-Up .....	1	TBA
715	122910A	Diff, JF506E (Freelan) 67T, No Groove (W/ 5 Small Windows In Hsg) 25 Axle Splines .....	1	TBA
715	122910B	Differential, JF506E (Mazda) 68 Teeth 4 Groove (With 2 Large Windows In Housing) .....	1	TBA
		29 Roller Bearing # 292 (30 Splines For Axles) 2002-Up .....		
715	122910C	Differential, JF506E (Volkswagen) 69 Teeth, No Groove (2 Large Windows In Housing) .....	1	TBA
		24 Roller Bearing #292 (30 Splines For Axles) 2002-Up .....		
715	122910D	Diff, JF506E (Jag) 68T, 4 Grv (W/10 Round Holes In Hsg) 24 Splines For Axles, 2002-Up .....	1	TBA
716	122911A	Differential Hsg, JF506E (Freelander) (With 5 Small Windows) (25 Splines For Axles) .....	1	TBA
716	122911B	Diff Hsg, JF506E (Mazda) (W/ 2 Large Windows) (29 Roller Brg #292) 30 Axle Splines .....	1	TBA
716	122911C	Diff Hsg, JF506E (VW) (W/ 2 Large Windows) (24 Roller Bearing #292) 30 Axle Splines .....	1	TBA
716	122911D	Differential Hsg, JF506E (Jaguar) (With 10 Round Holes) (24 Splines For Axles) 2002-Up .....	1	TBA
720	122845A	Ring Gear, JF506E (Freelan) 67T, No Grv (12 Bolt) 1.245" Thick (W/ 2 ID Grv On Top Side) .....	1	TBA
720	122845B	Ring Gear, JF506E (Maz/Jag) 68T, 4 Grv (12 Bolt) 1.245" Thk (W/ 3 ID Grv On Top Side) .....	1	TBA
720	122845C	Ring Gear, JF506E (VW) 69T, No Grv (12 Bolt) 1.245" Thick (No ID Groove On Top Side) .....	1	TBA
730	122846A	Pinion, JF506E (Freelander) 22 Teeth, 4 Groove (1.540" Thick) 2002-Up .....	1	TBA
730	122846B	Pinion, JF506E (Mazda/Jaguar) 21 Teeth, 3 Groove (1.520" Thick) 2002-Up .....	1	TBA
730	122846C	Pinion, JF506E (Volkswagen) 20 Teeth, No Groove (1.540" Thick) 2002-Up .....	1	TBA

### VALVE BODIES (DACCO VB#)

740	JA-5210J	Valve Body, JF506E, Jaguar, 9-Solenoid, 2002-Up .....	1	TBA
740	JA-5210J	Valve Body, JF506E, Land Rover, 9-Solenoid, 2002-Up .....	1	TBA
740	JA-5210M	Valve Body, JF506E, Mazda, 9-Solenoid, 2002-Up .....	1	TBA
740	JA-5210V	Valve Body, JF506E, VW, 9-Solenoid, 2002-Up .....	1	TBA

### VALVE BODIES

740	122754A	Valve Body, JF506E (Freelander) With 2 Tubes (All Stamped Steel Solenoid Brackets) .....	1	TBA
		(With 2 Countersunk Aluminum End Caps) 2002-Up .....		
740	122754B	Valve Body, JF506E (Mazda) With 1 Tube (With 2 Cast Iron Solenoid Brackets) .....	1	TBA
		(Cast # PM SUB) 2002-Up .....		
740	122754C	Valve Body, JF506E (Jaguar/Volkswagen) With 2 Tubes (All Stamped Steel Solenoid .....	1	TBA
		Brackets) (With 2 Flush Aluminum End Caps) 2002-Up .....		

### VALVE BODY COMPONENTS

741	122892-01K	Valve & Sleeve Kit, JF506E TCC Control Plunger (Sonnax) .....	1	122892-01K
-----	------------	---	---	------------

### HOUSINGS, CASES & PANS

750	122703A	Bell Hsg, JF506E (Freelan) (Cast # PRO43 By Seal) 12 Bolts To Case (Round Starter Hole) .....	1	TBA
750	122703B	Bell Hsg, JF506E (Maz) (Cast # PM2 By Seal & Filler Tube) 22 Bolts, Square Starter Hole .....	1	TBA
750	122703C	Bell Housing, JF506E (Volkswagen) (Cast # JP JC7 091 On Bottom) 21 Bolts To Case .....	1	TBA
		(Square Starter Hole) (External Oil Cooler On Top) 2002-Up .....		
750	122703D	Bell Hsg, JF506E (Jaguar) Cast # PLO42 Inside (23 Bolts To Case) (Square Starter Hole) .....	1	TBA
759	122704A	Rear Cover, JF506E (Freelander/Mazda/Jaguar) (Cast # PR000) 2002-Up .....	1	TBA
759	122704B	Rear Cover, JF506E (Freelander/Mazda/Jaguar) (Cast # PR002) 2002-Up .....	1	TBA
759	122704C	Rear Cover, JF506E (Volkswagen) (Cast # PWO) 2002-Up .....	1	TBA
760	122701A	Case, JF506E (Freelan) 21 Bolts To Bell (W/ Top Vent) (Uses Snap Ring To Hold In Servo) .....	1	TBA
760	122701B	Case, JF506E (Maz) 22 Bolts To Case (W/ Top Vent) (Uses Snap Ring To Hold In Servo) .....	1	TBA
760	122701C	Case, JF506E (VW) 21 Bolts To Case (No Top Vent) (Uses 3 Bolts To Hold In Servo) .....	1	TBA
760	122701D	Case, JF506E (Jag) 23 Bolts To Case (No Top Vent) (Uses Snap Ring To Hold In Servo .....	1	TBA
766	122803A	Pan, JF506E (Freelan) Side (2 Studs) (Dipstick Tube Is 3/4" Tall And At The Top In Center) .....	1	TBA
766	122803B	Pan, JF506E (Mazda) Side (No Studs) (No Filler Tube) 2002-Up .....	1	TBA
766	122803C	Pan, JF506E (Volkswagen) Side (4 Studs) (Filler Tube Is 3/4" Tall And Is At The Left Top Of .....	1	TBA
		Pan) (Metal Vent Is 1/4" OD Right Top) 2002-Up .....		
766	122803D	Pan, JF506E (Jaguar) Side (3 Studs) Filler Tube Is 7/8" Tall And Is At Left Top Of Pan .....	1	TBA
		(Plastic Vent Is 1 1/8" OD Right Top) 2002-Up .....		
783	122086	Bolt, JF506E, Support To Case .....	1	TBA
795	122948A	Nut, JF506E (All) Holds Drive Transfer Gear In Case (11 Outer Teeth) (1.340" ID) 2002-Up .....	1	TBA
796	122949A	Nut, JF506E (All) Reduction Planet Shaft (.885" ID) .553" Thick (6 Point) 2002-Up .....	1	TBA
798	122087	Bolt, JF506E (Volkswagen) Axle Flange To Differential (3 3/8" Long) (Both Sides) 2002-Up .....	2	TBA
838	122838	Axle Flange, JF506E (Volkswagen) Bell Housing Side (3 7/8" Long) 2002-Up .....	1	TBA
838	122838A	Axle Flange, JF506E (Volkswagen) Case Side (4 3/8" Long) 2002-Up .....	1	TBA

## JF506E (RE5F01A, 5F31J, JA5A-EL, 09A)

ILL#	Part#		QTY	REF#
<b>SPRINGS, PISTONS &amp; MISCELLANEOUS</b>				
853.....	122141	Cushion, JF506E (All) Low Clutch (.060" Thick) (Dished) 2002-Up .....	1	TBA
857.....	122142	Cushion, JF506E (All) Low/Reverse Clutch (.061" Thick) Beveled (6 9/16" OD) 2002-Up.....	1	TBA
858.....	122143	Cushion, JF506E (All) High Clutch (.063" Thick) 18 Teeth (Dished) (3.608" ID) 2002-Up.....	1	TBA
NI.....	K122928	Snap Ring Kit, JF506E, 2002-Up .....	1	TBA
905.....	122987A	Servo Assy, JF506E (Freelander) Reduction Brake (#908 Piston Is 1.955" OD) 2002-Up.....	1	TBA
905.....	122987B	Servo Assy, JF506E (Mazda/Jaguar) Reduction Brake (#908 Piston Is 2.270" OD) .....	1	TBA
905.....	122987C	Servo Assembly, JF506E (Volkswagen) Reduction Brake (3 Bolt Cover) 2002-Up.....	1	TBA
906.....	122624	Spring, JF506E (All) Reduction Brake Servo (.855" OD) (2.065" Long) 2002-Up.....	1	TBA
906.....	122624A	Spring, JF506E (Freelander/Mazda/Jaguar) Non Tapered (1.020" Long) 2002-Up .....	1	TBA
906.....	122624B	Spring, JF506E (Volkswagen) Reduction Brake Servo (Tapered) (1.020" Long) 2002-Up .....	1	TBA
907.....	122526A	Piston, JF506E (Freelander/Jaguar) Reduction Brake (Straight Neck) (1.955" OD) 2002-Up .....	1	TBA
907.....	122526B	Piston, JF506E (Mazda/Jaguar) Reduction Brake (With Stepped Neck) (1.955" OD) .....	1	TBA
907-5	122605A	Snap Ring, JF506E (All) Holds Reduction Brake Servo Piston #908 In The Case .....	1	TBA
908.....	122527A	Piston, JF506E (Freelander) Reduction Brake Servo (1.955" OD)(2.860" Long Pin) 2002-.....	1	TBA
908.....	122527B	Piston, JF506E (Maz/Jag/VW) Reduction Brake Servo (2.270" OD, 2.470" Long Pin) .....	1	TBA
908-5	122625	Spacer, JF506E (All) Reduction Brake Servo Piston (With 6 Oval Slots) (.126" Thick).....	1	TBA
909.....	122626	Cover, JF506E (Freelander/Mazda/Jaguar) Reduction Brake Servo (2.515" OD) 2002-Up .....	1	TBA
909.....	122626A	Cover, JF506E (Volkswagen) Reduction Brake Servo (Bolt-On Type) (1.970" ID) 2002-Up.....	1	TBA
909-5	122605B	Snap Ring, JF506E (All) Holds Reduction Brake Servo Piston #907 In Cover (.040" Thick) .....	1	TBA
916.....	122627	Band Anchor, JF506E (Freelander/Volkswagen) (6 Point Hex Head) 2002-Up .....	1	TBA
916.....	122627A	Band Anchor, JF506E (Mazda/Jaguar) (6 Point Fluted Head) 2002-Up.....	1	TBA
925.....	122988A	Accumulator Assy, JF506E (All) Low Clutch (Upper One In Valve Body) (Plastic Piston).....	1	TBA
		(End Cap Is .482" Thick, 1.612" OD) (Spring Is 3.085" Long, 1.062" OD) 2002-Up .....		
930.....	122988B	Accumulator Assembly, JF506E (All) 2-4 Brake Clutch (In Rear Cover) (Plastic Piston) .....	1	TBA
		(End Cap Is .640" Thick, 1.612" OD) (Spring Id 2.863" Long, 1.062" OD) 2002-Up.....		
935.....	122988C	Accum Assy, JF506E (All) High Clutch (Lower One In Valve Body) (Plastic Piston) .....	1	TBA
		(End Cap Is .482" Thick, 1.612" OD) (Spring Is 2.905" Long, 1.062" OD) 2002-Up.....		
945.....	122988D	Accum Assy, JF506E (All) Low/Rev Cl (In Rear Of Case) (Alum Piston) (End Cap Is .560" .....	1	TBA
		Thk, 1.635" OD) (Outer Spring Is 2.085" Long, 1.055" OD, Inner Spring 2.135", .785" OD .....		
957.....	122736A	Housing, JF506E (Freelander/Volkswagen) Low/Reverse Clutch Piston (.805" Thick).....	1	TBA
957.....	122736B	Housing, JF506E (Mazda/Jaguar) Low/Reverse Clutch Piston (.850" Thick) 2002-Up .....	1	TBA
961.....	122762A	Piston, JF506E (Freelan/Maz/Jag) Direct Cl (.330" Thick At Edge) 3.980" OD, 2.22" ID .....	1	TBA
961.....	122762C	Piston, JF506E (VW) Direct Clutch (.270" Thick At The Edge) 3.980" OD (2.220" ID).....	1	TBA
962.....	122763A	Piston, JF506E (All) 2-4 Brake Cl (Aluminum) 20 Legs (1.545" Thk) (7 1/2" OD) 2002-Up .....	1	TBA
964.....	122764A	Piston, JF506E (Freelander/Volkswagen/Mazda) Low Clutch (1.260" Thick) (Aluminum) .....	1	TBA
964.....	122764D	Piston, JF506E (Jaguar) Low Clutch (1.390" Thick) (Aluminum) 2002-Up.....	1	TBA
965.....	122765A	Piston, JF506E (All) High Clutch (Aluminum) (.890" Thick) 4.405" OD (1.970" ID) 2002-Up .....	1	TBA
967.....	122766A	Piston, JF506E (Freelander) Low/Reverse Clutch (.905" Thick) (Aluminum) 2002-Up.....	1	TBA
967.....	122766B	Piston, JF506E (Mazda) Low/Reverse Clutch (.805" Thick) (Aluminum) 2002-Up.....	1	TBA
967.....	122766C	Piston, JF506E (Volkswagen) Low/Reverse Clutch (.780" Thick) (Aluminum) 2002-Up .....	1	TBA
967.....	122766D	Piston, JF506E (Jaguar) Low/Reverse Clutch (1.040" Thick) (Aluminum) 2002-Up .....	1	TBA
971.....	122631A	Spring, JF506E (All) Direct Clutch Return (Spiral) (2.625" OD) 2002-Up.....	1	TBA
972.....	122632A	Spring, JF506E (All) 2-4 Brake Cl Return (16 Springs) .920" Thk (6 11/16" ID) 2002-Up .....	1	TBA
974.....	122633A	Spring, JF506E (All) Low Clutch Return (Spiral Type) (4.290" OD) 2002-Up.....	1	TBA
975.....	122634A	Spring, JF506E (All) High Clutch Return (Spiral) 1.075" Thick (2.875" OD) 2002-Up.....	1	TBA
977.....	122635A	Spring, JF506E (All) Low/Reverse Clutch Return (Spiral Type) (8" OD) 2002-Up .....	1	TBA
979.....	122636A	Spring, JF506E (Volkswagen) Axle Flange To Differential (1.725" OD) (1" Tall) 2002-Up .....	1	TBA
981.....	122641A	Retainer, JF506E (All) Direct Clutch Spring (2.820" OD) 2002-Up.....	1	TBA
984.....	122642A	Retainer, JF506E (All) Low Clu Spring (.300" Thick) (Alum) 5.065" OD (12 ID Notches).....	1	TBA
985.....	122643A	Retainer, JF506E (All) High Clutch Spring (Bonded) 4.120" OD (1.655" ID) 2002-Up .....	1	FP01-19-2A1
987.....	122644A	Retainer, JF506E (All) Low/Reverse Clutch Spring (Tin) (7 5/16" OD) 2002-Up.....	1	TBA
989.....	122645A	Retainer, (Cup) JF506E (VW) Axle Flange Spring To Washer #275 (1.840" OD) W/ 2 Ears.....	1	TBA
991.....	K122621	Linkage Assy, JF506E (Jaguar/Freelander) Internal (15-3/16" Long Rod With 2 O-Rings) .....	1	TBA
991.....	K122621A	Linkage Assy, JF506E (Mazda) Internal (11-3/8" Long Rod With No O-Rings) 2002-Up .....	1	TBA
991.....	K122621B	Linkage Assembly, JF506E (Volkswagen) Internal (10-1/2" Long Rod With No O-Rings).....	1	TBA
991-4	122622	Linkage Rod, JF506E (Jaguar/Freelander) (15-3/16" Long) .....	1	TBA
991-4	122622A	Linkage Rod, JF506E (Mazda) (11-3/8" Long) .....	1	TBA
991-4	122622B	Linkage Rod, JF506E (Volkswagen) (10-1/2" Long).....	1	TBA
991-7	122623	Sleeve, JF506E (All) Manual Shaft To Case (Plastic) (.485" ID) 2002-Up.....	1	TBA
994.....	122628	Park Actuator, JF506E (Jaguar/Freelander/Mazda) 6 1/2" Long Rod With Clip 2002-Up .....	1	TBA
994.....	122628A	Park Actuator, JF506E (Volkswagen) 5 3/4" Long Rod With Clip 2002-Up .....	1	TBA
995.....	122824A	Park Pawl Assembly, JF506E (Jaguar/Freelander) 2002-Up .....	1	TBA
995.....	122824B	Park Pawl Assembly, JF506E (Mazda) 2002-Up.....	1	TBA
995.....	122824C	Park Pawl Assembly, JF506E (Volkswagen) 2002-Up .....	1	TBA
998.....	122480	Oil Cooler, JF506E (Volkswagen) External (1 Bolt, 3 3/4" Long) 2002-Up.....	1	TBA