

## Component Description

### AIR INTAKES, AIR CLEANERS AND AIR DUCTS

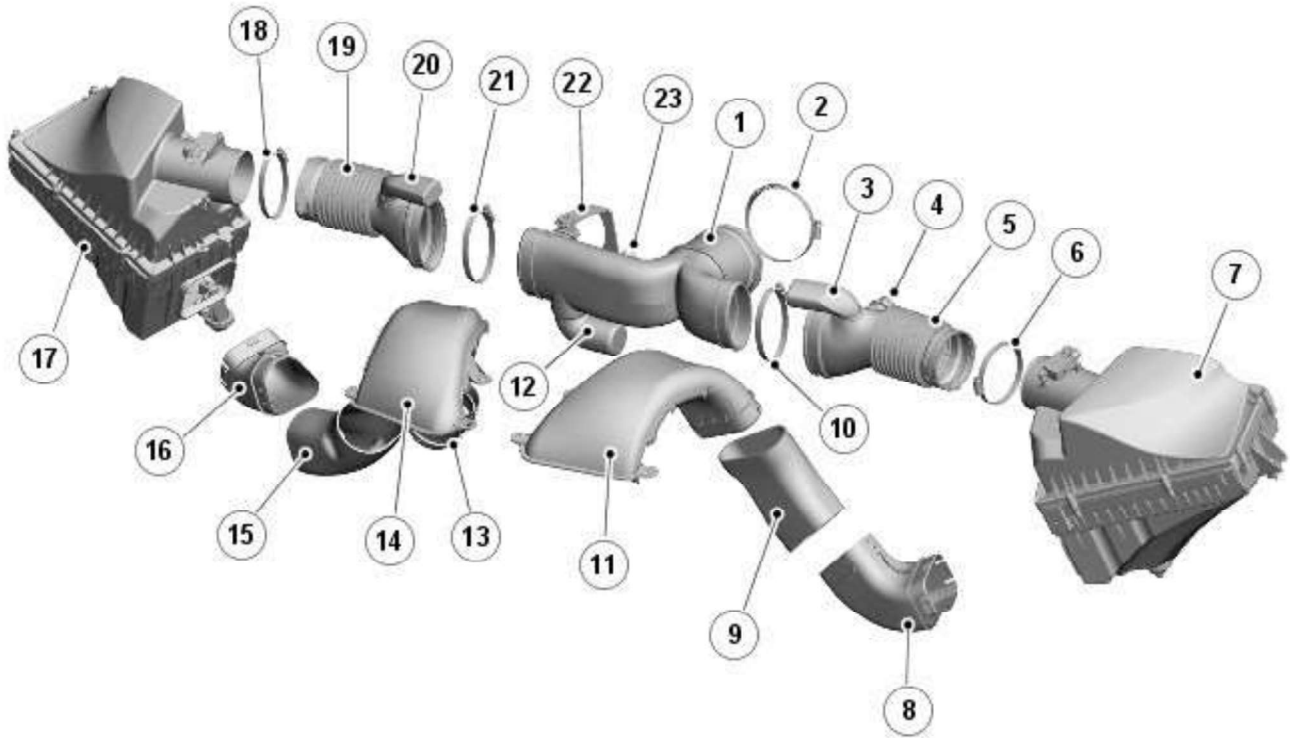

E118128

Item	Description
1	Throttle T-piece duct
2	Hose clamp
3	Quarter wave resonator
4	Full load breather connector stub
5	LH (left hand) air cleaner outlet tube
6	Hose clamp
7	LH air cleaner
8	LH air cleaner lower intake duct
9	LH air cleaner center intake duct
10	Hose clamp
11	LH air cleaner intake scoop
12	Quarter wave resonator
13	RH air cleaner support intake duct
14	RH (right hand) air cleaner intake scoop
15	RH air cleaner center intake duct
16	RH air cleaner lower intake duct
17	RH air cleaner
18	Hose clamp
19	RH air cleaner outlet tube
20	Quarter wave resonator
21	Hose clamp
22	Mounting grommet and bracket
23	Bypass valve actuator connector stub

Air intake scoops and ducts supply air from behind the front crossmember to the air cleaners. The air intake scoops, ducts and air cleaner are locked together by latches and matching recesses molded into the mating joint faces.

The air cleaners are located in the forward corners of the engine compartment, on the fender front aprons. Each air cleaner is located on the related fender front apron and front side member by two supports, and secured to a bracket at the top of the fender front apron by a bolt and grommet.