

EMS PRIMARY SENSING COMPONENTS

Engine Coolant Temperature Sensor (ECTS) – AJ26 and AJ27

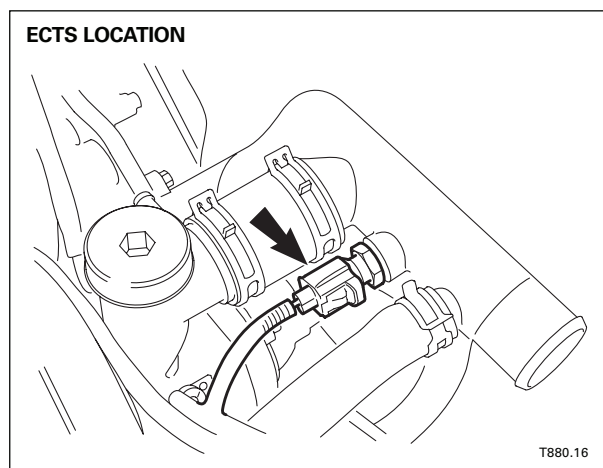

- The ECTS is located on the coolant outlet elbow between the A and B bank cylinder heads.
- The ECTS is a negative temperature coefficient (NTC) thermistor.
- The ECM applies 5 volts to the sensor and monitors the voltage drop through the thermistor.
- Engine coolant temperature is determined by the ECM by a change in resistance within the sensor.

ECTS Temperature / Resistance

Coolant temperature		Resistance (k Ω)
$^{\circ}\text{C}$	$^{\circ}\text{F}$	
-10	14	9.20
0	32	5.90
20	68	2.50
40	104	1.18
60	140	0.60
80	176	0.325
100	212	0.19

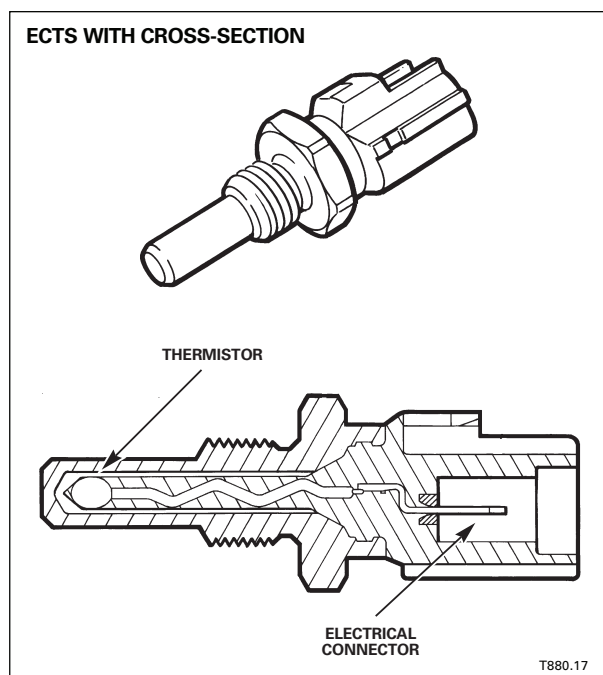

ECTS Temperature / Voltage

Coolant temperature		Voltage (V)
$^{\circ}\text{C}$	$^{\circ}\text{F}$	
-10	14	4.05
0	32	3.64
20	68	2.42
40	104	1.78
60	140	1.17
80	176	0.78
100	212	0.55

NOTES