

Transmission Control Switch (TCS) (44.15.12)

Removal

- 1 . Open the driver's door, or both doors if necessary, to allow the side glass to drop. Ensure that the doors remain open until after the battery has been disconnected.
- 2 . Position the selector to 'N' to provide clearance for removing the console.
- 3 . Disconnect the vehicle battery ground lead.
- 4 . Remove the J-gate surround, operation 76.25.24.
- 5 . Remove the console finisher veneer panel, operation 76.47.26.
- 6 . Remove the console assembly, operation 76.25.01.
- 7 . Detach the selector cable from the gear shift assembly.
 - 1) Remove the nut which secures the inner cable to the shift lever.
 - 2) Slacken the outer cable locknuts. Move the cable clear.

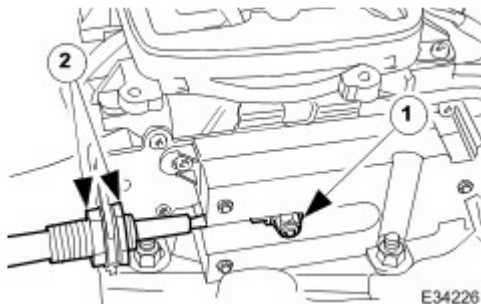

- 8 . Disconnect the electrical connector from the linear switch.

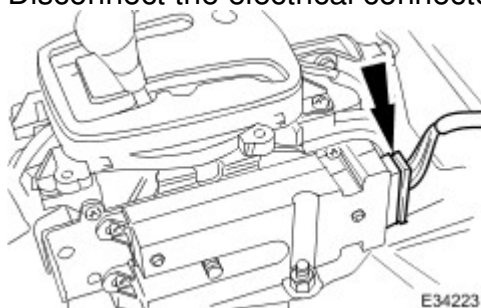

- 9 . Position the selector to 'P' to align the mechanism for installing the new linear switch.

10 . Remove the linear switch.

- ▶ Remove the four screws.
- ▶ Remove the linear switch from the mounting bracket.

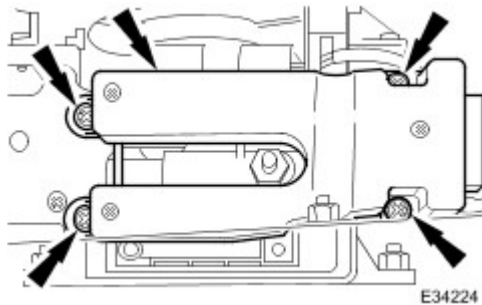

Installation

1 . Install the linear switch.

- ▶ Position the linear switch to the mounting bracket.
- ▶ Align the drive peg and lower sliding block of the switch to the mating components of the selector mechanism.

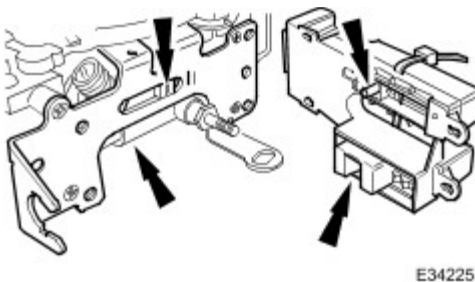

2 . Install the four screws, but do not fully tighten.

- ▶ Remove the Ty-Strap from the dual linear switch.
- ▶ Use the manual release and reposition the selector to 'N' for installation of the selector cable.

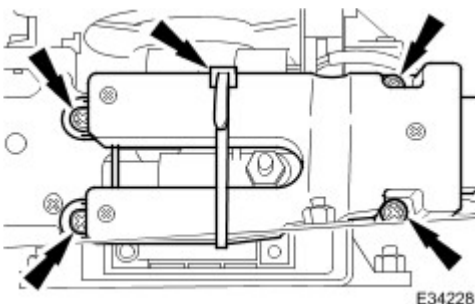

3 . Connect the electrical connector to the linear switch.

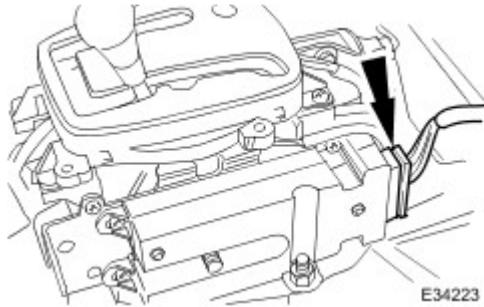

4 . Assemble the cable to the gear shift assembly.

- 1) Locate the outer cable and fit the inner cable to the gear selector arm. Tighten to 22-28 Nm.
- 2) Position the abutment nuts to the approximate position, but do not tighten.

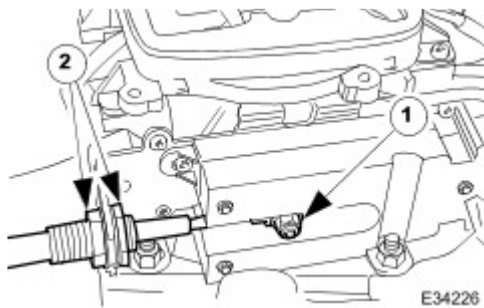

5 . **NOTE :**

When setting the selector cable, ensure that the selector lever on the transmission casing is still in the 'N' position.

Adjust the selector cable from inside the vehicle.

- 1) Confirm that the selector lever is in the 'N' position.
Adjust the nuts to lock against the bracket without moving the set
- 2) position of either the gear selector lever or the selector lever on the transmission casing.
- 3) Tighten to 22-28 Nm.
- 4) Verify the 'N' setting.

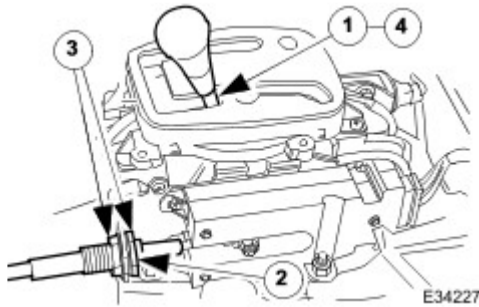

- 6 . Check that all released connectors are safely insulated and connect the vehicle battery.
- 7 . Switch ON the ignition.
- 8 . Adjust the position of the linear switch so that the selector 'N' position graphic illuminates. Tighten the four screws to 0,7-1 Nm.
- 9 . Move the gear selector to 'R' to confirm that the 'R' position graphic illuminates.
- 10 . Check that the engine will start when the gear selector is in the 'N' and 'P' positions, but not in any other position.
- 11 . Move the gear selector to 'N'.
- 12 . Switch OFF the ignition.
- 13 . Disconnect the battery.
- 14 . Install the console assembly, operation 76.25.01.
- 15 . Install the console finisher veneer panel, operation 76.47.26.
- 16 . Install the J-gate surround, operation 76.25.24.
- 17 . Perform the Battery Reconnection Procedure described in Operation 86.15.15.