



V8 XJ Series

DATE 10/00

501-46

SERVICE

TECHNICAL BULLETIN

Memory Buttons Hot To Touch –
Component Serviceability –
Repair ProcedureMODEL 1998 MY-ON
V8 XJ Series

VIN 812256-ON

Issue:

Lower wattage bulbs and window isolation buttons are now available to address customer complaints of the following:

- Excessively hot memory buttons in the window switch pack – hot to touch.
- Missing window isolation button.

Note: The bulbs within the switch pack (Illustration 1) should only be replaced for the above complaint or if they are faulty or blown. Vehicles up to VIN F11700 were equipped with 100 ma bulbs for the seat memory control buttons, which then changed to 50 ma bulbs. Do not replace complete switch packs for such complaints, as this will result in the non-payment of the warranty claim.

Action:

To replace the bulbs and/or the isolation button, follow the procedure below:

REPLACING SWITCH PACK BULBS

Record the following system settings **prior** to disconnecting the battery so that they may be reset to the customers preferred setting.

- Clock time setting.
- CD compress mode (if equipped. Radio must be in CD mode to check this setting.)
- Navigation volume defaults to 0 (if equipped)
- Gear box mode.
- Radio presets AM/FM.

The trip computers (both A & B) will reset to zero, these however cannot be returned to prior readings.

1. Disconnect the car battery. (See workshop manual, JTIS CD ROM section 414-01, SRO 86.15.01).

2. Remove the door casing. (See workshop manual, JTIS CD ROM section 501-05, SRO 76.34.01).
3. Disconnect the switch pack connector.
4. Remove the armrest to expose the switch pack assembly. (See workshop manual, JTIS CD ROM section 501-11. SRO 86.46.12).
5. Using a screwdriver and a small pair of pointed tweezers, remove the bulb from the switch pack assembly (Illustration 1) (Refer to SRO 86.46.12). **Replace the memory position bulbs (item 1, Illustration 1) with 50 ma bulbs (blue base) only.**

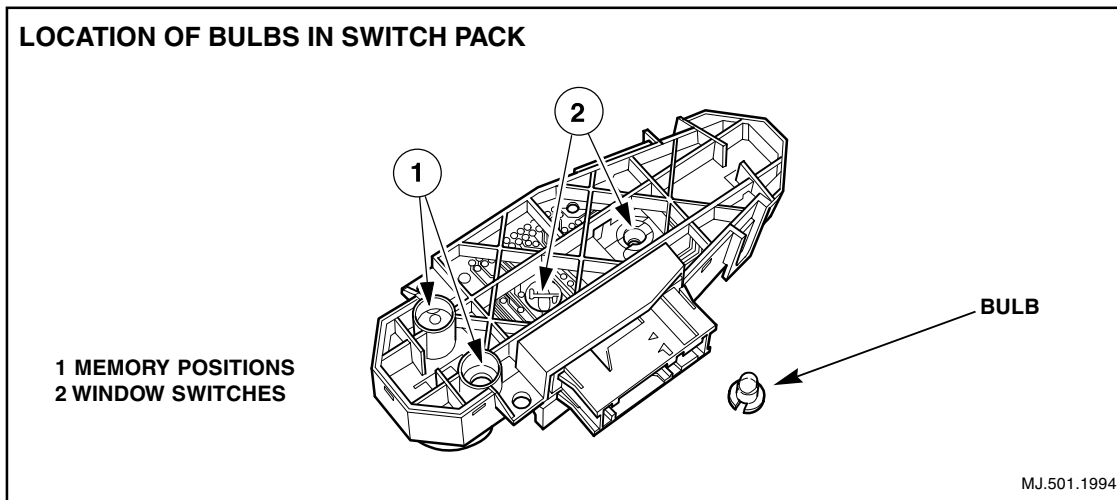

ILLUSTRATION 1

6. If missing or damaged, install a new isolation button into the switch pack ensuring it is fully depressed into the housing or until an audible click is heard. (See item 1, Illustration 2). Button can be removed with a small pair of tweezers/pliers.

Note: The isolation button can either be replaced at this stage in the procedure, when the switch pack is easily accessible, or, it can be replaced while the switch pack is still in the door casing assembly.

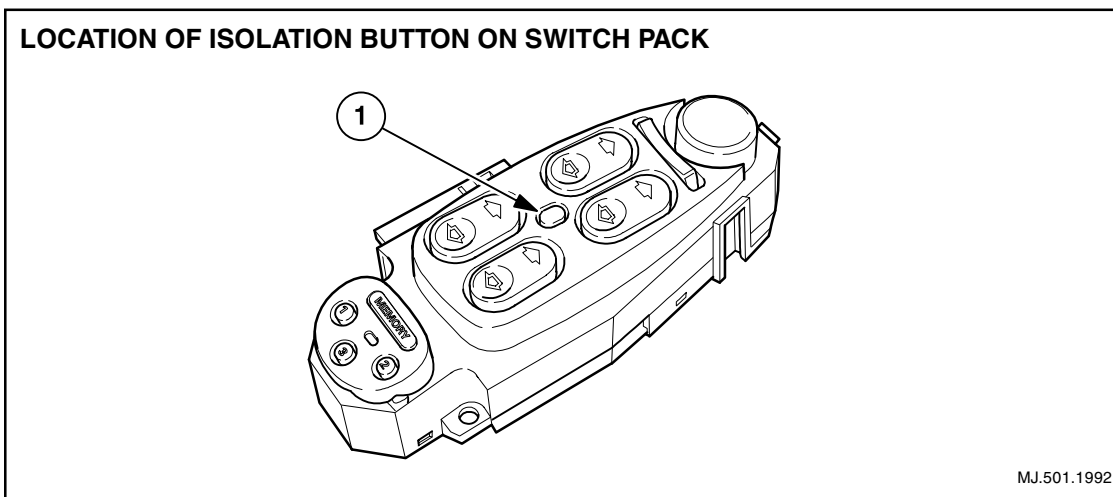

ILLUSTRATION 2

7. Reinstall the armrest to the door casing assembly. (See workshop manual, JTIS CD ROM section 501-11 SRO, 86.25.07).
8. Reconnect the switch pack connector.
9. Reinstall the door casing. (See workshop manual, JTIS CD ROM section 501-05, SRO 76.34.01).
10. Reconnect the car battery. (See workshop manual, JTIS CD ROM section 414-01, SRO 86.15.01).

Parts Information:

<u>DESCRIPTION</u>	<u>PART NUMBER</u>	<u>COMMENTS</u>
Bulb 50 ma - Blue base with blue cover - memory Isolation Button	JLM 21555	as per TSB
Bulb 100 ma - Black base with blue cover - switches	JLM 21567 JLM 21554	only if faulty

Warranty Information:

<u>FAULT CODE</u>	<u>R.O. NUMBER</u>	<u>DESCRIPTION</u>	<u>TIME ALLOWANCE</u>
WY BC 46	86.92.62	Replacing Bulb	0.45 hrs.
WY BB 39	86.25.59	Replacing Isolation Button	0.10 hrs.