

2000 XJ RANGE - Front Suspension - 204-01

Spring

Special Service tools

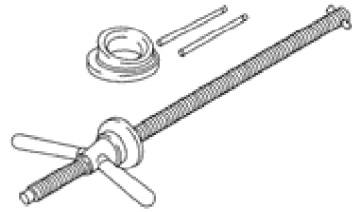

E36463

Road spring compressor
204-111 (JD115)

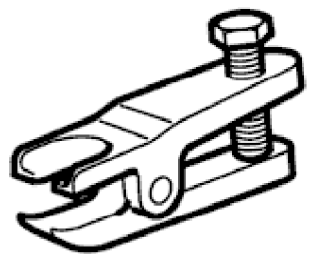

E36397

Taper separator
211-098 (JD 100)

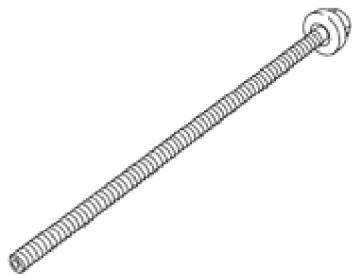

E36462

Ball Joint Taper Separator
204-192 (JD 219)

2000 XJ RANGE - Front Suspension - 204-01



Removal **CAUTION:**

Replacement of nuts and bolts: Various thread-locking devices are used on nuts and bolts throughout the vehicle. These devices restrict the number of times a nut or bolt can be used. See section <<100-00>> for information.

1. Raise front of vehicle to provide access for Special Tool 204-111. Refer to Section <<100-02>>
2. Remove appropriate road wheel. Refer to Section <<100-02>>.

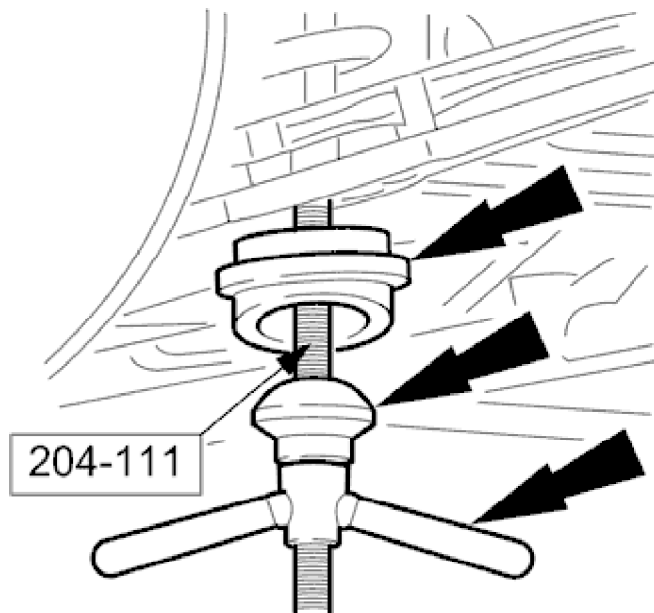

E35086

3. Install Special Tool 204-111 in road spring.
 - Slacken tool adjuster to suit spring length.
 - Install adaptor and thrust collar.
 - Position stem of tool in center of spring passing dowel through slot in suspension turret.

2000 XJ RANGE - Front Suspension - 204-01

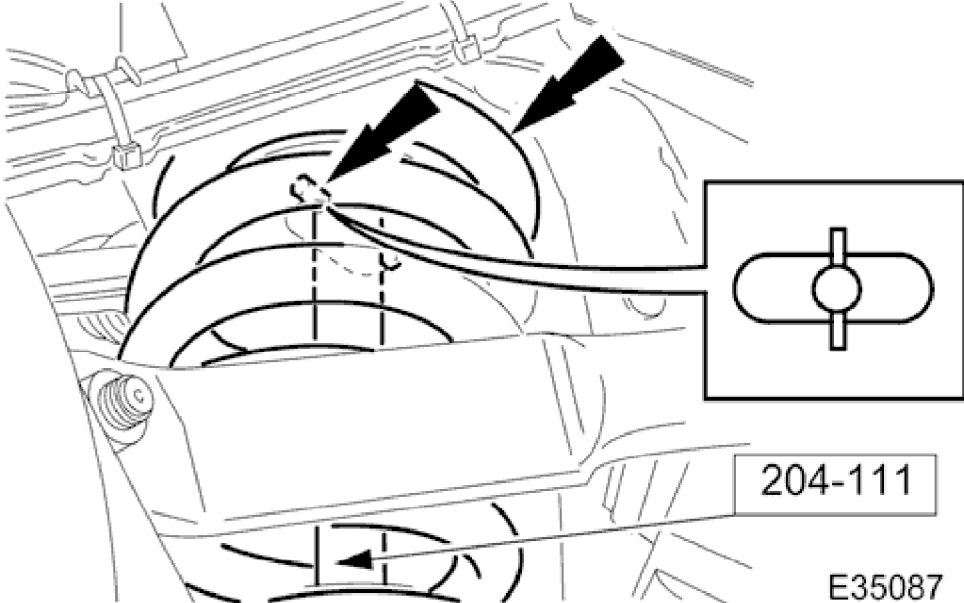

4. Rotate stem of Special Tool 204-111 to position dowel across slot.

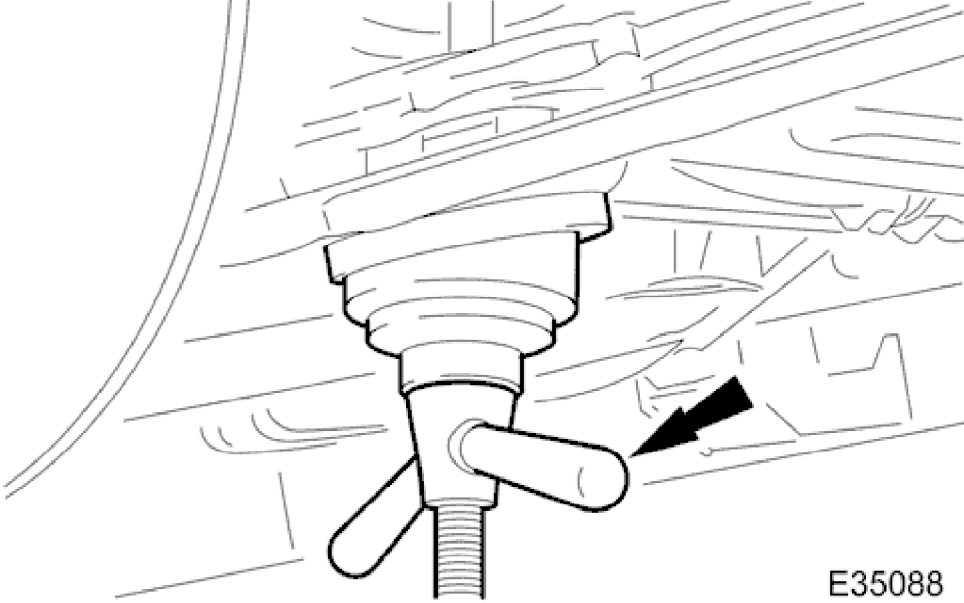

5.  **WARNING:**
WHEN TURNING TOOL ADJUSTER, ENSURE THAT TOOL STEM DOES NOT ROTATE AND DISTURB POSITION OF DOWEL IN SUSPENSION TURRET.

Rotate adjuster of Special Tool to tension spring.

2000 XJ RANGE - Front Suspension - 204-01

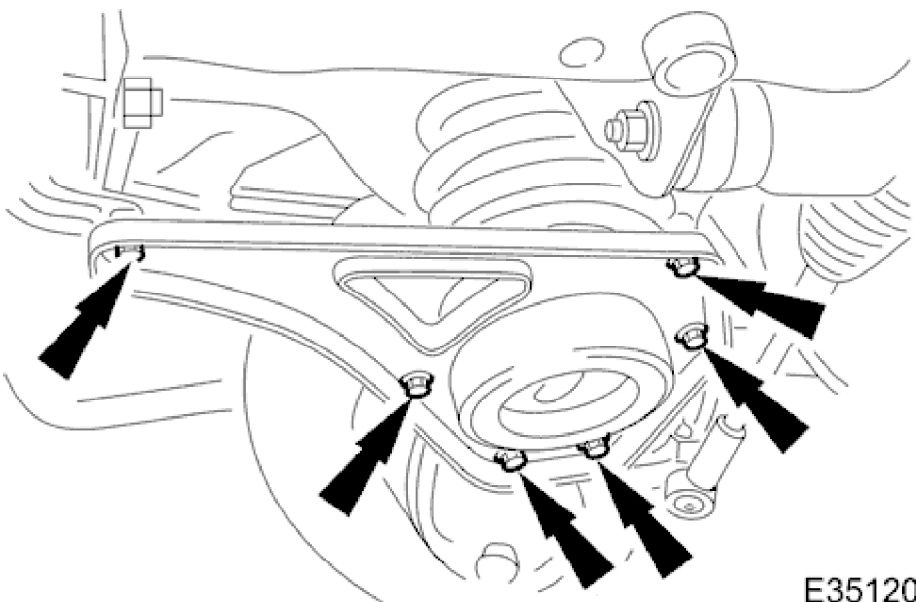

6. Remove spring pan to lower wishbone securing bolts.

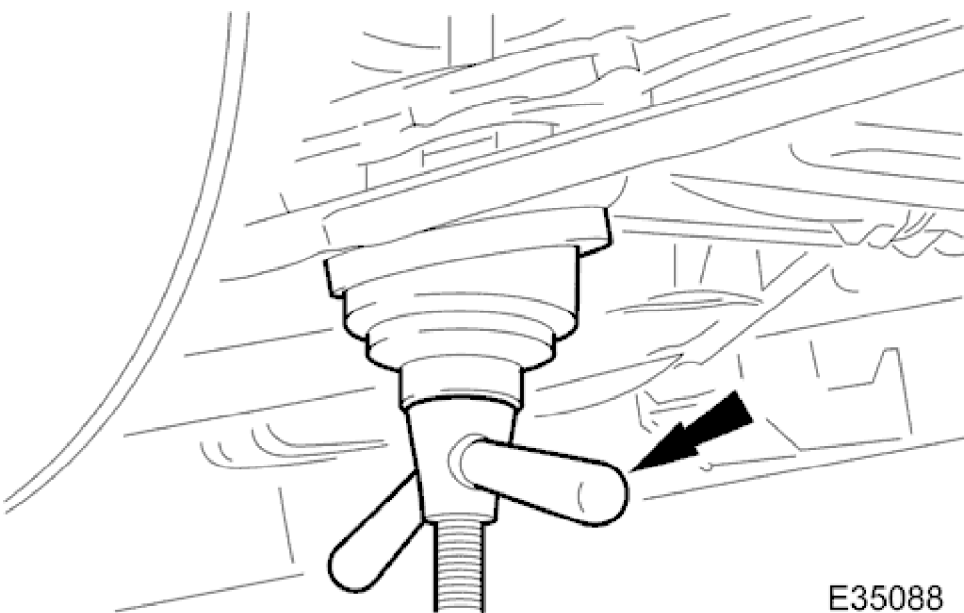

7.  **WARNING:**
WHEN TURNING TOOL ADJUSTER, ENSURE THAT TOOL STEM DOES NOT ROTATE AND DISTURB POSITION OF DOWEL IN SUSPENSION TURRET.

Rotate adjuster of Special Tool to release tension from spring.

8. Remove spring assembly and Special Tool from suspension turret.

9. Remove Special Tool from spring assembly.

2000 XJ RANGE - Front Suspension - 204-01

Installation

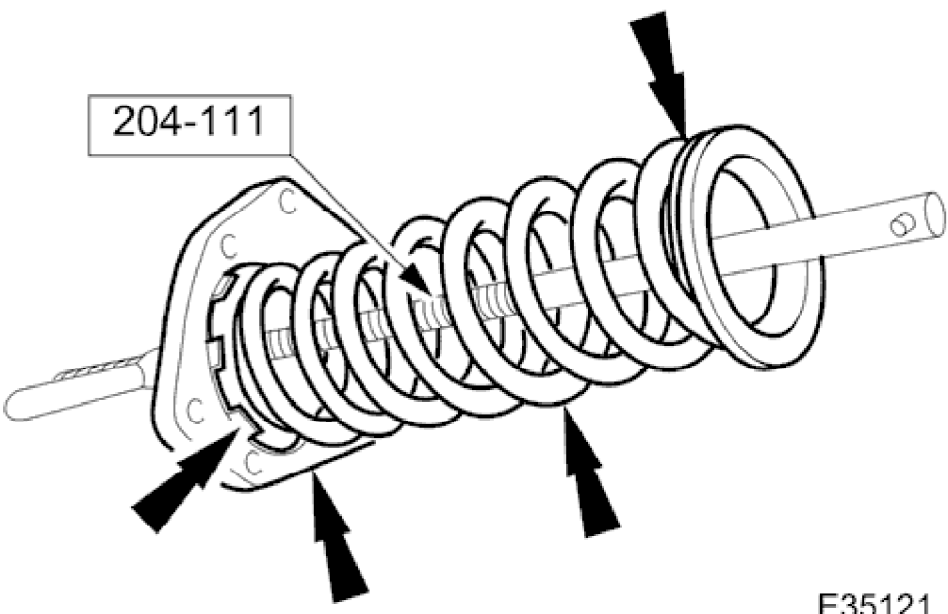

E35121

1. Install spring pan, new spring and new spring rubber upper and lower seats on Special Tool 204-111.

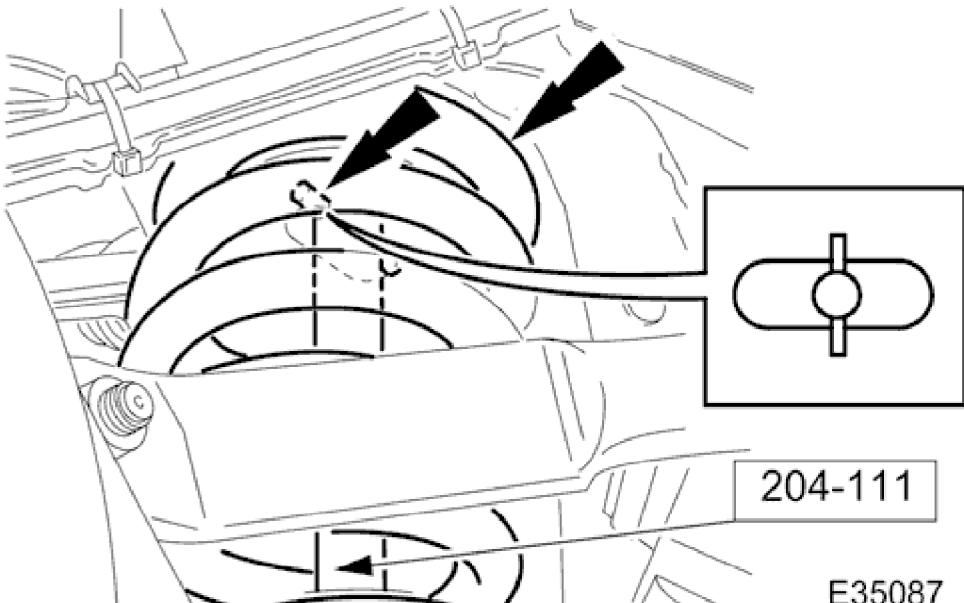

2. Install Special Tool 204-111 and spring assembly in suspension turret.
- Position spring assembly and Special Tool in suspension turret.
 - Ensure spring upper rubber seat is correctly positioned and fully seated.
 - Engage tool dowel in turret slot.

2000 XJ RANGE - Front Suspension - 204-01

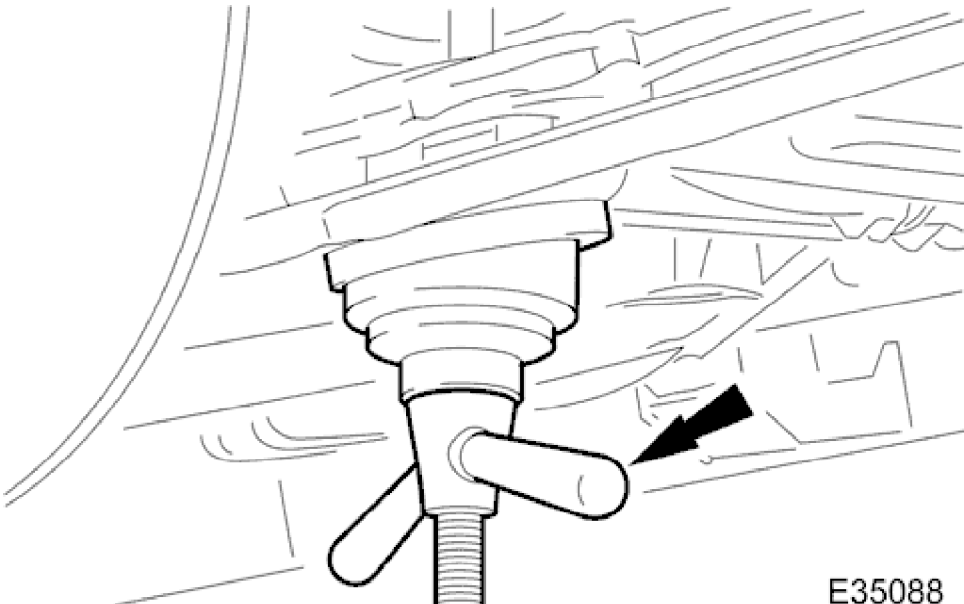

E35088

- 3. Position spring pan on lower wishbone.
 - Rotate adjuster of Special Tool to lightly tension spring.
 - Align spring pan with lower wishbone bolt locations.

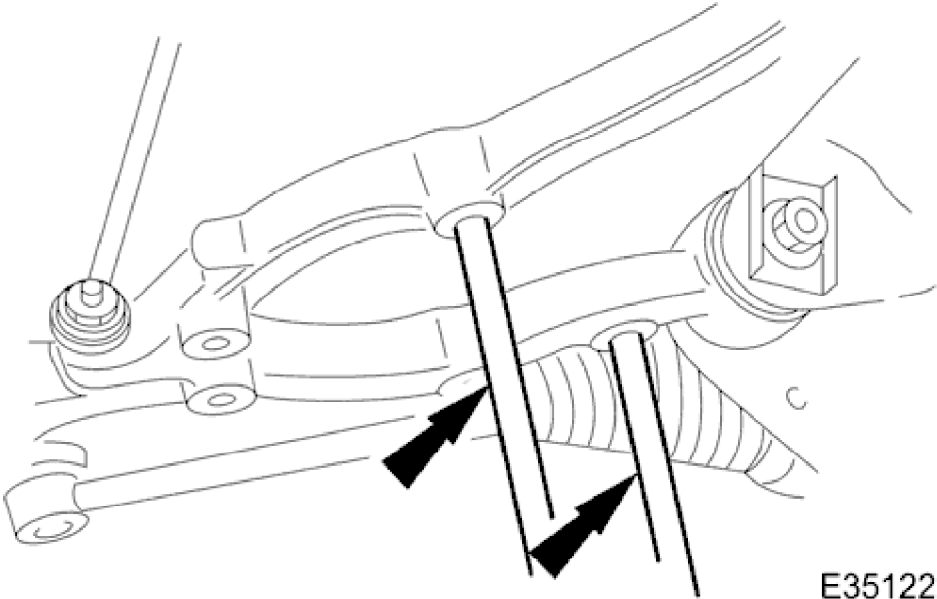

E35122

- 4. Install suitable guide pins in spring pan/wishbone bolt locations.

2000 XJ RANGE - Front Suspension - 204-01

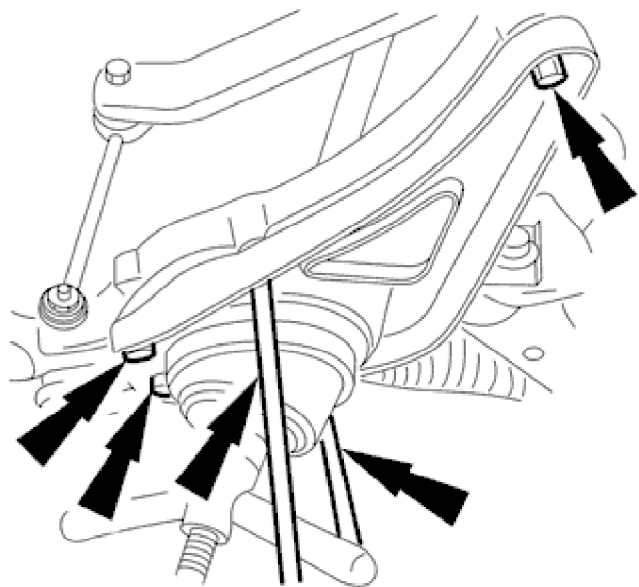

E35123

5.  **WARNING:**
WHEN ROTATING TOOL ADJUSTER, ENSURE THAT TOOL STEM DOES NOT TURN AND DISTURB POSITION OF DOWEL IN SUSPENSION TURRET.

Install spring pan to wishbone securing bolts.

- Rotate tool adjuster to gradually increase spring tension.
- Progressively substitute spring pan securing bolts for guide pins.
- Tighten spring pan securing bolts to 70-90Nm.

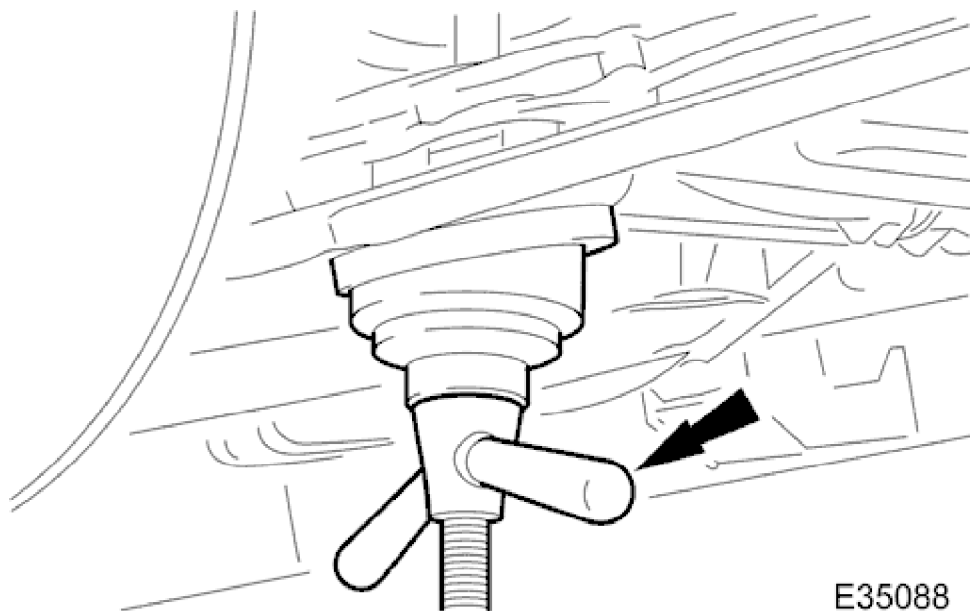

E35088

6.  **WARNING:**
WHEN ROTATING TOOL ADJUSTER, ENSURE THAT TOOL STEM DOES NOT TURN AND DISTURB POSITION OF DOWEL IN SUSPENSION TURRET.

Remove Special Tool 204-111 from suspension.

2000 XJ RANGE - Front Suspension - 204-01

- Ensure spring lower rubber seat is correctly positioned and fully seated.
- Rotate adjuster of Special Tool to release tension on spring.

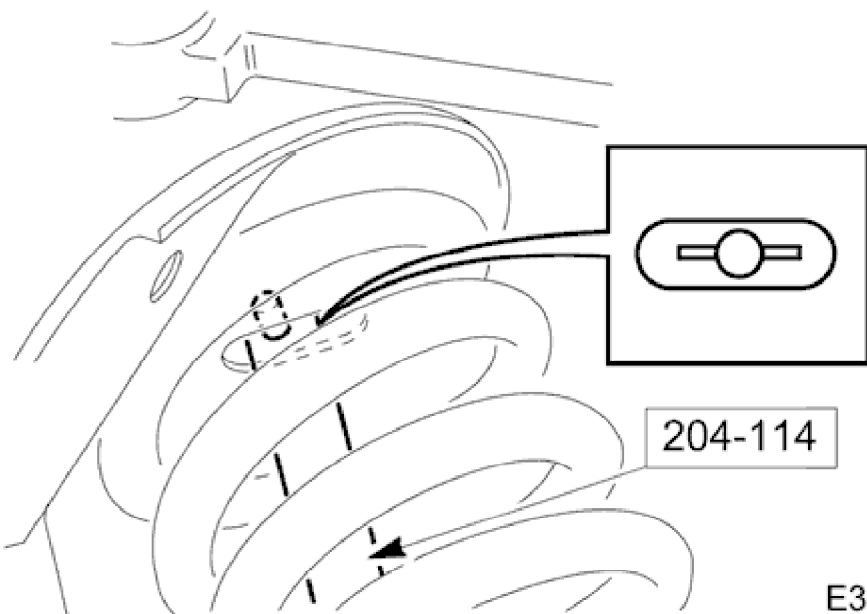

7. Rotate tool stem to release dowel from turret and withdraw tool assembly.

8. Lower vehicle to working height and support on stands.

9. Install road wheel. Refer to Section <<100-02>>.

10. Raise vehicle, remove stands and lower vehicle onto road wheels.