

SUN VISORS

- Remove and refit** 76.10.47
- Removing**
- 1 Remove two screws securing visor bracket to headlining trim rail.
 - 2 Lift off visor.

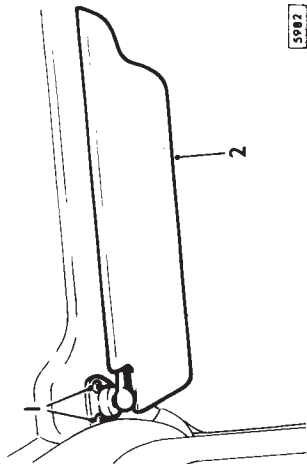

- Refitting**
- Reverse operations 1 and 2.

INTERIOR MIRROR

- Remove and refit** 76.10.51
- Removing**
- 1 Remove screws securing mirror arm to headlining trim rail, lift off mirror.
- NOTE:** It is possible to detach mirror arm from mounting bracket by applying tension to mirror arm until arm disengages from socket in mounting bracket.

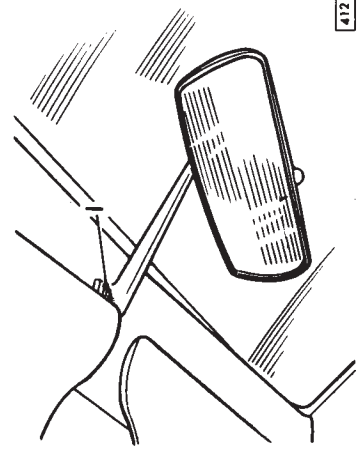

- Refitting**
- 2 Fit mirror arm to headlining trim rail, secure with screws.
 - 3 If mirror detached at socket, position arm ball in socket mouth and strike rear of ball with heel of hand.

EXTERIOR MIRROR (REMOTE CONTROLLED)

- Remove and refit** 76.10.52
- Removing**
- 1 Remove two screws securing adjusting lever surround to door trim.
 - 2 Partially withdraw adjusting lever and surround from trim.
 - 3 Slacken grub screw securing surround to adjusting lever, withdraw surround from lever.
 - 4 Remove two screws securing mirror to door.
 - 5 Remove mirror and mounting pad, carefully withdrawing adjusting cable through door.

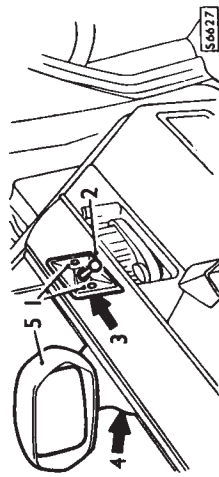

- Refitting**
- Reverse operations 1 to 5.

FRONT TRIM CASING

- Remove and refit** 76.13.01
- Removing**
- 1 Remove door sill tread plate, see 76.76.01.
 - 2 Remove underscuttle casing, see 76.46.11.
 - 3 Release 8 in. (200 mm.) of draught welting.
 - 4 Peel trim from lip of door aperture.

- 5 Remove two screws securing trim casing to side of footwell.
- 6 Disengage trim casing from air vent regulator control and lift casing from car.

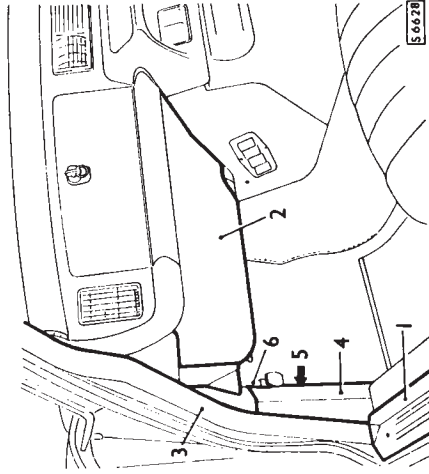

- Refitting**
- 7 Reverse operations 1 to 6; apply suitable sealing compound to area of trim covering draught welting locating lip.
 - 8 Check operation of fresh air control.

'A' POST TRIM CASING

- Remove and refit** 76.13.07
- Removing**
- 1 Remove fascia crash roll, see 76.46.04.
 - 2 Remove screw securing trim casing to mounting plate.
 - 3 Slacken nut securing trim casing mounting plate to screen rail.
 - 4 Swing mounting plate inwards, i.e. away from trim casing.
 - 5 Disengage trim casing from locating clip and lift from car.

- Refitting**
- Reverse operations 1 to 5.

'B' POST TRIM CASING — FOUR DOOR CARS

- Remove and refit** 76.13.08
- Removing**
- 1 Prise interior light cover from 'B' Post.
 - 2 Carefully prise trim casing from 'B' Post.

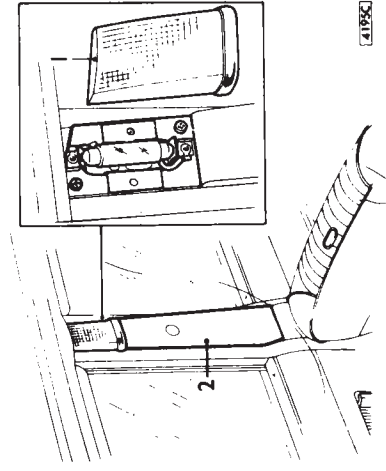

- Refitting**
- Reverse operations 1 and 2.

CANTRAIL CRASH ROLL — FOUR DOOR CARS

- Remove and refit** 76.13.10
- Removing**
- 1 Remove screws securing coat hook to cantrail, lift off hook.
 - 2 Prise cantrail complete with crash roll from roof rail.

Refitting
Reverse operations 1 and 2.

CANTRAIL CRASH ROLL — TWO DOOR CARS

- Remove and refit** 76.13.10
- Removing**
- 1 Disconnect battery, see 86.15.20.
 - 2 Remove interior light, see 86.45.04.
 - 3 Remove rear quarter crash roll, see 76.13.15.
 - 4 Remove rear passenger grab handle, see 76.58.30.
 - 5 Remove rear parcel shelf, see 76.67.06.
 - 6 Remove two screws located in interior light aperture securing cantrail to roof rail.
 - 7 Carefully disengage cantrail securing clips from roof rail.

Refitting
Reverse operations 1 to 7.

REAR QUARTER TRIM CASING — TWO DOOR CARS

- Remove and refit** 76.13.14
- Removing**
- 1 Remove rear seat squab, see 76.70.38.
 - 2 Remove door sill tread plate, see 76.76.01.
 - 3 Release 8 in. (200 mm.) of draught welting from rear of door aperture.
 - 4 Remove bolt securing seat belt lower anchorage plate to sill, note position of washers, spacers and spring.
 - 5 Unclip plastic casing covering seat belt upper anchorage plate, remove belt securing anchor plate to body.
 - 6 Remove screw securing chrome bezel to front of armrest, slide bezel forward and disengage from armrest.

- 7 Remove screw exposed by removal of bezel.
- 8 Peel trim from lip of door aperture.
- 9 Prise edges of trim casing from body.
- 10 Feed seat belt through guide aperture in trim casing.
- 11 Lift casing from car.

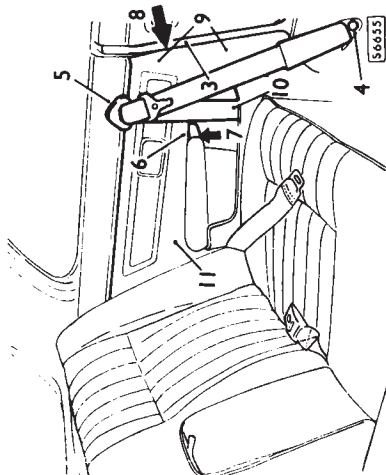

Refitting
Reverse operations 1 to 11.

REAR QUARTER CRASH ROLL — TWO DOOR CARS

- Remove and refit** 76.13.15
- Removing**
- 1 Remove rear quarter trim casing, see 76.13.14.
 - 2 Remove two screws securing crash roll to body.
 - 3 Push crash roll forward and disengage from locating pegs.
 - 4 Raise crash roll and lift from car.

Refitting
Reverse operations 1 to 4.

BONNET

- Remove and refit** 76.16.01
- Removing**
- 1 Disconnect battery, see 86.15.20.
 - 2 Disconnect cables feeding headlamps at snap connectors.
 - 3 Remove nut and bolt securing bonnet stay to bonnet.

- 4 Remove six bolts, spring washers and flat washers securing bonnet to hinges, lift bonnet from hinges.

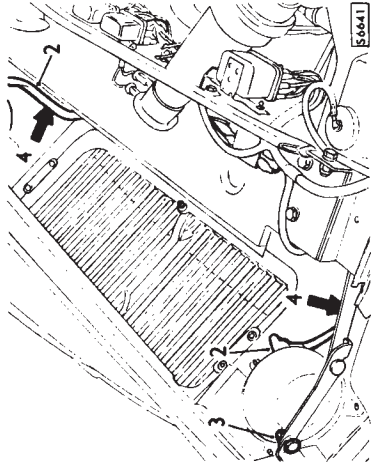

- Refitting**
- 5 Fit bonnet to hinges, do not fully tighten securing bolts.
 - 6 Close bonnet and centralise if necessary.
 - 7 Open bonnet and fully tighten securing bolts.
 - 8 Reverse operations 1 to 3.

BONNET HINGES

Remove and refit — Non Federal 76.16.12

- Removing**
- 1 Remove bonnet, see 76.16.01.
 - 2 Remove bonnet assist springs, see 76.16.13.
 - 3 Remove lower grille, see 76.55.06.
 - 4 Remove four bolts from inside wheel arch securing sides of front apron panel to body.
 - 5 Remove three screws securing underside of apron panel to body.
 - 6 Carefully withdraw apron panel from car.
 - 7 Remove radiator, see 26.40.04.
 - 8 Remove three bolts, flat washers and star washers securing hinge and bumper mounting bracket to subframe.
 - 9 Remove bonnet hinge and bumper mounting bracket from subframe.

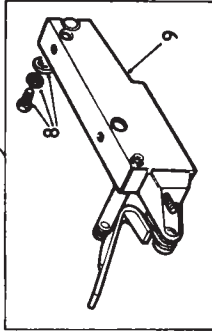
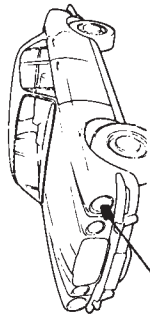

Refitting
Reverse operations 1 to 9. Cover with underseal bolts securing mounting bracket assembly and area where bracket enters subframe.

BONNET ASSIST SPRING

- Remove and refit** 76.16.13
- Removing**
- 1 Remove front bumper, see 76.22.08.
 - 2 Open bonnet and remove nut and bolt securing stay to bonnet, allow bonnet to fully open.
 - 3 Using suitable screwdriver, unhook spring from upper fixing point.
 - 4 Unhook spring from lower fixing point and lift from car.

Refitting
Reverse operations 1 to 4.

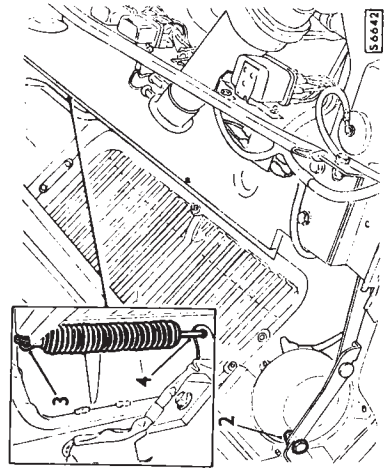

REAR BUMPER

Remove and refit 76.22.15

- Removing**
- 1 Remove four bolts and flat washers securing bumper assembly to side mounting brackets.
 - 2 Supporting bumper, remove two bolts, flat washers and spring washers securing bumper to rear mountings.
 - 3 Lift bumper from car.

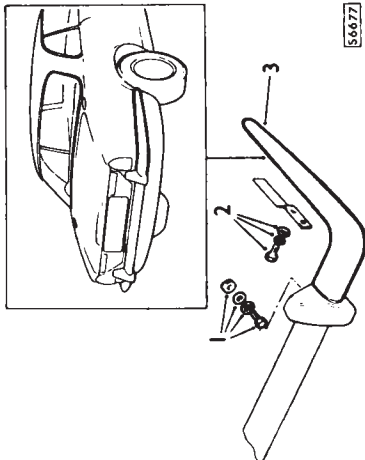

REAR BUMPER SIDE SECTION

Cars to U.S.A. Federal specification only
Remove and refit 76.22.13

- Removing**
- 1 Remove three bolts securing side section to mounting brackets, recover flat and spring washers.
 - 2 Remove nut and spring washer securing side section to centre blade.
 - 3 Lift side section from car; recover plastic beading located between mating faces of sections.

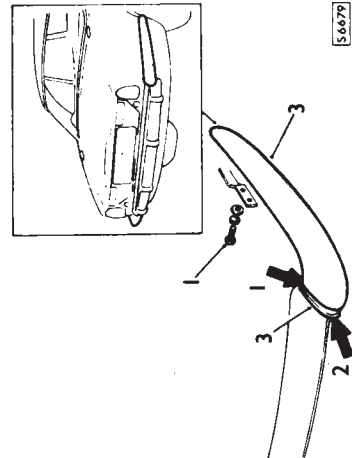

Refitting
Reverse operations 1 to 3.

ENERGY ABSORBING BEAM -- FRONT

Cars to U.S.A. Federal specification only
Remove and refit 76.22.26

- Removing**
- 1 Remove front beam cover, see 76.22.28.
 - 2 Remove self locking nuts securing beam mounting bolts.
 - 3 Noting quantity and relative position of beam adjustment shims remove bolts securing beam to struts, recover shims.
 - 4 Lift beam from struts.

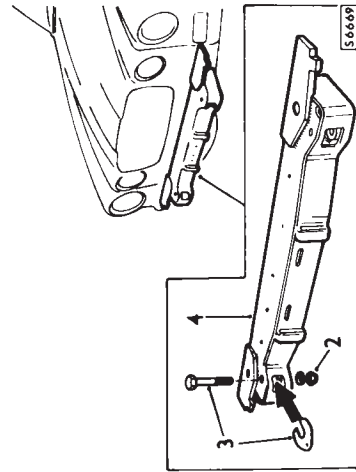

Refitting
Reverse operations 1 to 4.

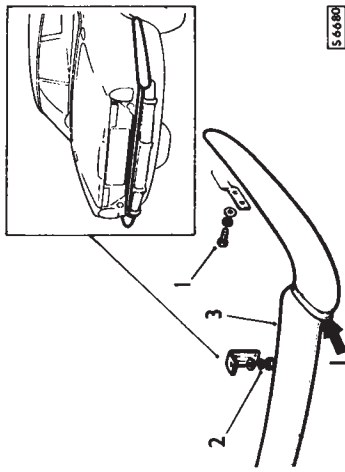

ENERGY ABSORBING BEAM -- REAR

Cars to U.S.A. Federal specification only
Remove and refit 76.22.27

- Removing**
- 1 Remove rear energy absorbing beam cover, see 76.22.29.
 - 2 Remove self locking nuts securing beam mounting bolts, recover guide tubes and adjusting shims, position and location of shims should be noted.
 - 3 Withdraw beam mounting bolts and flat washers.
 - 4 Lift beam from car.

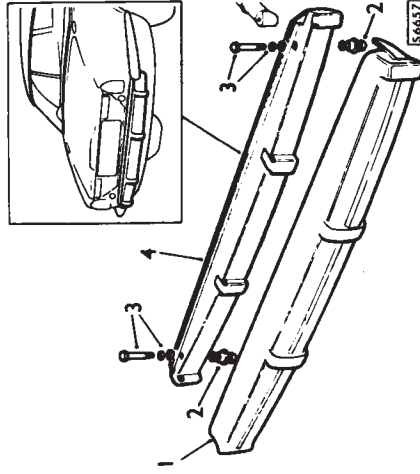

Refitting
Reverse operations 1 to 4.

ENERGY ABSORBING BEAM COVER -- FRONT

Cars to U.S.A. Federal specification only
Remove and refit 76.22.28

- Removing**
- 1 Remove front bumper, see 76.22.08.
 - 2 Prise off clips and remove oval washers securing cover to beam.
 - 3 Lift cover from beam.

continued

Refitting
Reverse operations 1 to 4.

ENERGY ABSORBING STRUT – FRONT

Cars to U.S.A. Federal specification only
Remove and refit 76.22.31

- 1 Remove front energy absorbing beam, see 76.22.26.
- 2 Open bonnet and remove nut and flat washer securing strut to mounting tube.
- 3 Position energy absorbing beam mounting bolt in strut locating hole. Gently tapping bolt head with hammer remove strut from mounting tube.

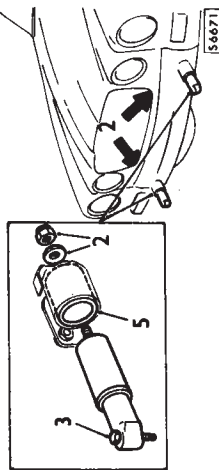

- Inspection**
- 5 Examine rubber sleeve in strut mounting tube for any signs of damage or deterioration.
 - 6 Reposition strut in mounting tube and check for any radial movement. If rubber sleeve is damaged or radial movement between strut and sleeve exists a new rubber sleeve must be fitted.

Refitting
Reverse operations 1 to 4.

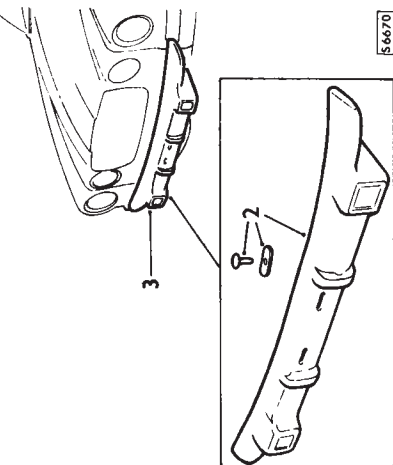

Refitting
Reverse operations 1 to 3.

ENERGY ABSORBING BEAM COVER – REAR

Cars to U.S.A. Federal specification only
Remove and refit 76.22.29

- 1 Remove rear bumper assembly, see 76.22.15.
- 2 Slacken six bolts securing underside of cover to inner face of energy absorbing beam.
- 3 Disengage locating clips from beam cover.
- 4 Peel cover from beam.

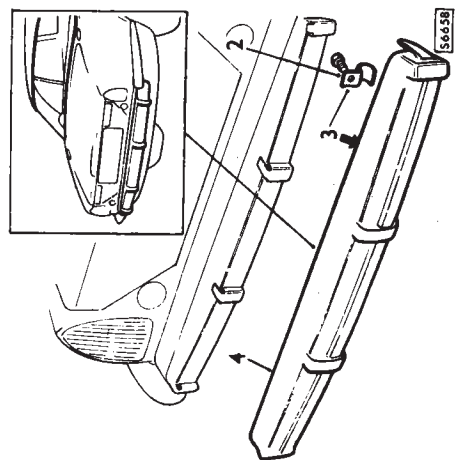

ENERGY ABSORBING STRUT – REAR

Cars to U.S.A. Federal specification only
Remove and refit 76.22.32

- 1 Remove rear energy absorbing beam, see 76.22.27.
- 2 Remove tail pipe and rear silencer, see 30.10.22.
- 3 Remove nut securing strut to mounting tube, recover flat washer.
- 4 Position energy absorbing beam mounting bolt in strut locating hole. Gently tapping bolt head with hammer, remove strut from mounting tube.

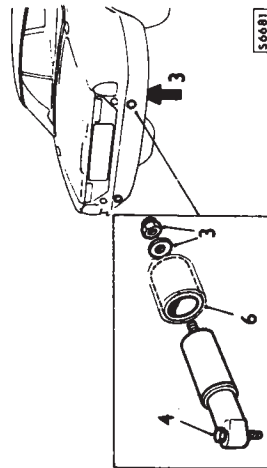

- Inspection**
- 6 Examine rubber sleeve in strut mounting tube for signs of damage or deterioration.
 - 7 Reposition strut in mounting tube and check for any radial movement. If rubber sleeve is damaged or radial play between strut and sleeve exists, a new sleeve must be fitted.

Refitting
Reverse operations 1 to 5.

CONSOLE ASSEMBLY

Remove and refit 76.25.01

Removing

NOTE: Throughout the following operation where electrical leads are detached from switches etc., a note as to their position should be made.

- 1 Disconnect battery, see 86.15.20.
- 2 Remove console side trim casings, see 76.25.02.
- 3 Pull off heater and ventilation control knobs.
- 4 Withdraw panel sufficiently to allow access to centre shelf securing screws. Care must be taken not to damage fibre optic elements.
- 5 Remove four screws securing centre shelf to console and fascia.
- 6 Detach temperature air sensor pipe from centre shelf, position tray clear of console.
- 7 Prise window switch panel from console top finisher. Care must be taken not to disconnect leads feeding window lift switches.
- 8 Remove three screws securing top finisher to console.
- 9 Raise top finisher and detach leads from cigar lighter and door lock switch.
- 10 Feed window switch panel and switches through aperture in top finisher.
- 11 Lift finisher from console.

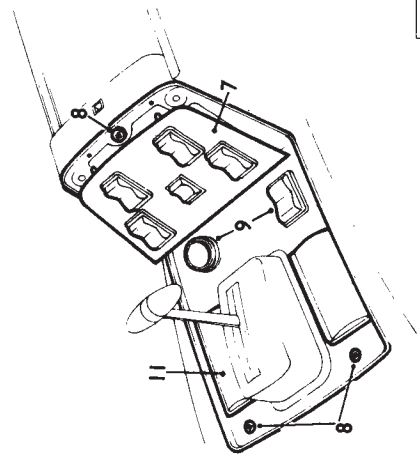

56682

DOOR GLASS — TWO DOOR CARS Remove and refit 76.31.01

Removing

- 1 Remove door crashroll, see 76.34.17.
- 2 Remove three screws securing glass bezel/guide to front of door, lift bezel/guide from door.
- 3 Remove five screws securing crash roll retaining plate, lift plate from door.
- 4 Prise free anti-rattle pads fitted between door frame and glass.
- 5 Remove nuts and bolts retaining lower portion of polythene sheet to door, position sheet clear of window lift mechanism.
- 6 Lower window sufficient to allow access to four screws securing window mounting plate.
- 7 Slacken four screws securing window mounting plate to lift mechanism.
- 8 Slacken two nuts securing window lift quadrant guide channel to glass mounting.
- 9 Raise window to full extent.
- 10 Remove two screws securing glass to mounting plate.

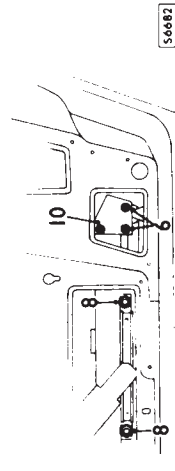
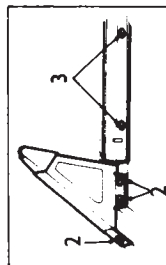

- 11 Remove rubber grommet sealing glass to door shut face.
 - 12 Carefully ease glass from mounting plate and lift from door.
- ### Refitting
- 13 Position glass between mounting plates.
 - 14 Refit glass retaining screws, do not fully tighten screws.
 - 15 Lower glass to allow access to mounting plate securing screws.

- 16 Slightly tighten mounting plate securing screws.
- 17 Raise glass to full extent.
- 18 Refit door glass front guide.
- 19 Close door and adjust glass to obtain a 9/32 in. (7 mm.) clearance between drip rail and glass edge.
- 20 Open door and fully tighten mounting plate securing screws.
- 21 Lower glass and fully tighten mounting plate securing screws.
- 22 Fully tighten window lift guide securing nuts.
- 23 Resecure lower portion of polythene sheet.
- 24 Refit grommet to door shut face.
- 25 Refit door glass anti-rattle pads.
- 26 Refit crash roll mounting plate.
- 27 Refit crash roll and trim casing.

REAR DOOR GLASS — FOUR DOOR CARS

Remove and refit 76.31.02

- ### Removing
- 1 Remove rear door trim casing, see 76.34.04.
 - 2 Prise chrome trim free from door glass frame.
 - 3 Remove screw securing inner chrome trim to door glass frame, prise trim from frame.
 - 4 Release rubber seal from door glass frame.
 - 5 Lower door glass and release upper portion of felt channel fitted to quarter light.
 - 6 Remove screws exposed by removal of felt channel.
 - 7 Remove two screws, adjacent to B.C. Post securing vertical door glass frame to top glass frame and gently tap top glass frame free, lift frame from door.
 - 8 Remove screws securing glass buffer stop to door panel, lift buffer stop from door.
 - 9 Remove screw securing window lift mechanism to door panel.
 - 10 Disengage window lift arm from glass guide bracket.
 - 11 Withdraw glass from door.
 - 12 Remove guide bracket and seal from glass.

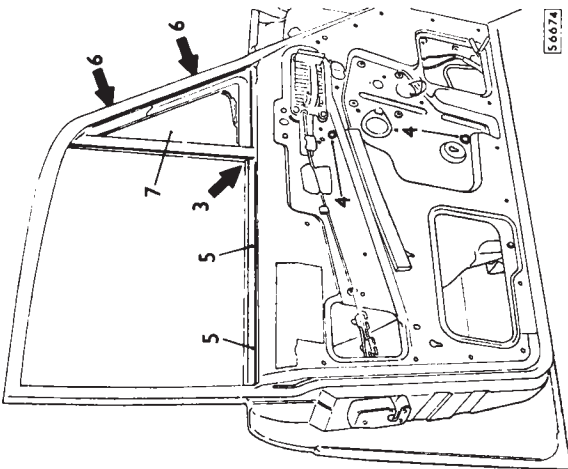

- ### Refitting
- Reverse operations 1 to 7, apply suitable sealing compound between quarter light and chrome beading.

REAR DOOR QUARTER LIGHT — FOUR DOOR CARS

Remove and refit 76.31.31

- ### Removing
- 1 Remove rear door trim casing, see 76.34.04.
 - 2 Prise chrome trim free from quarter light frame.
 - 3 Prise chrome beading from base of quarter light.
 - 4 Remove screw securing inner chrome trim to door glass frame, prise trim from quarter light frame.
 - 5 Release section of door seal fitted to quarter light frame.
 - 6 Remove three screws securing base of quarter light to door.
 - 7 Lower door glass to full extent.
 - 8 Release upper portion of felt channel fitted to quarter light.

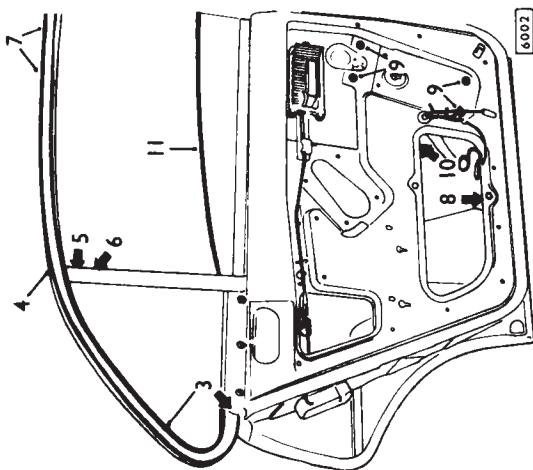

- ### Refitting
- 13 Locate new seal in correct position over glass.
 - 14 Position lift arm guide bracket over seal, using mallet gently tap either side of guide until seal and guide are firmly secured to glass.
 - 15 Reverse operations 1 to 11.

FRONT DOOR QUARTER LIGHT — FOUR DOOR CARS

Remove and refit 76.31.28

- ### Removing
- 1 Remove front door trim casing, see 76.34.01.
 - 2 Lower door glass to full extent.
 - 3 Prise free chrome beading along base of quarter light.
 - 4 Remove two bolts securing quarter light support leg to door panel.
 - 5 Remove screws securing glass weatherstrip to door, lift weatherstrip from door.
 - 6 Remove two screws securing quarter light to angled section of door glass frame.
 - 7 Manoeuvre quarter light assembly free from door.

continued