

INTERIOR TRIM AND ORNAMENTATION

REAR QUARTER TRIM SLIDING PANEL (G1307925)

REMOVAL AND INSTALLATION

REMOVAL

1. Remove the rear seat backrest.

For additional information, refer to: Rear Seat Backrest (501-10, Removal and Installation).

- 2.

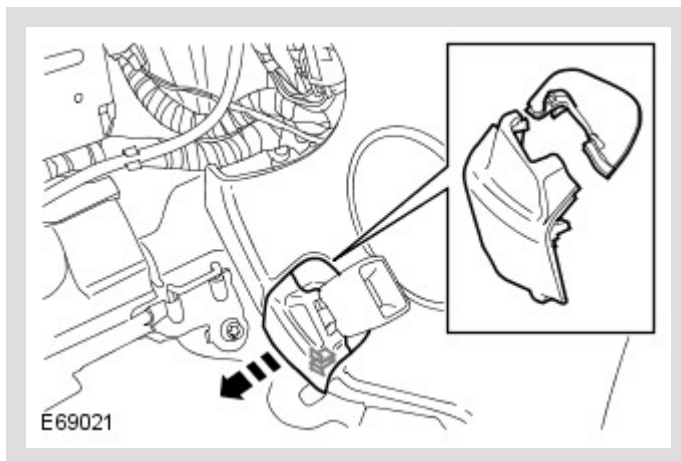

Remove the rear safety belt stalk trim panel.

Release from the clip.

- 3.

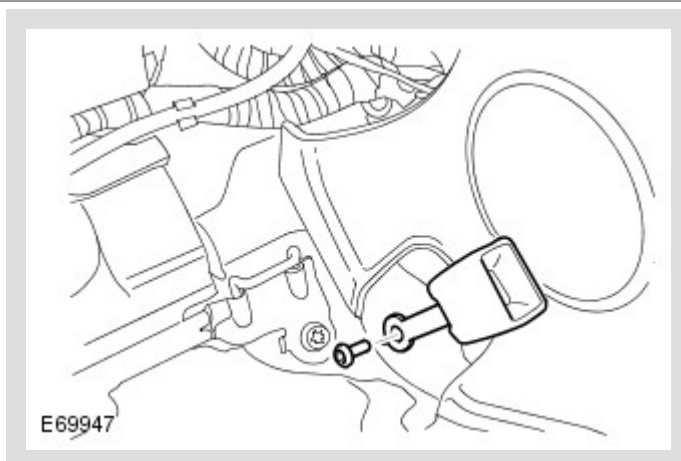

Remove the rear safety belt stalk.

Remove the Torx bolt.

4.

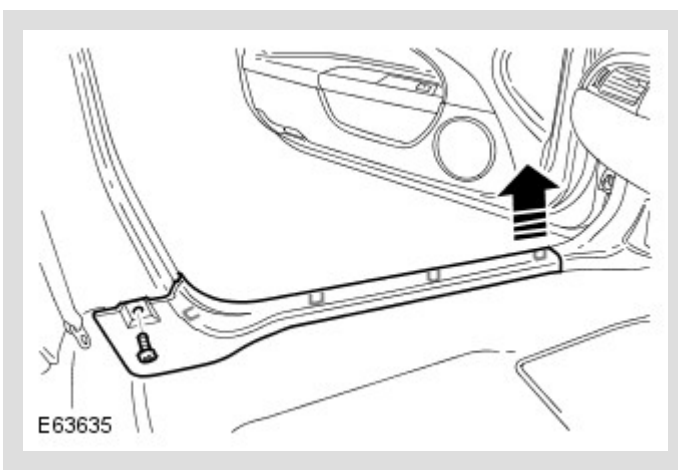

Remove the scuff plate trim panel.

Remove the Torx bolt.

Release from the 4 clips.

5.

 **NOTE:**

Support the convertible top lid.

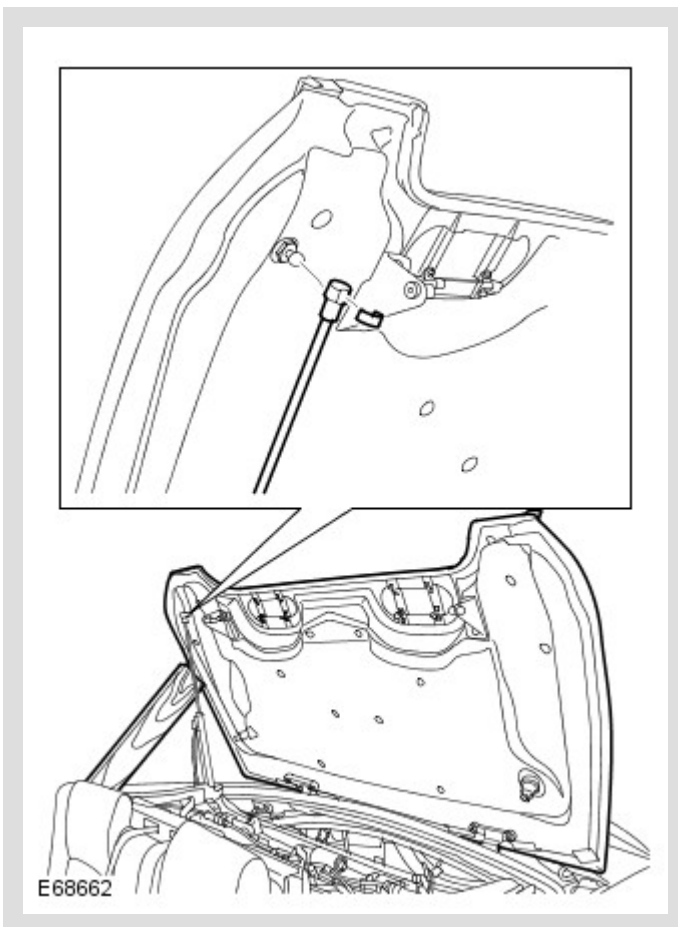

Open the convertible top to the position shown.

Depress the switch.

6.

Release the convertible top hinge cover tension strap.

Release from the convertible top mechanism.

7.

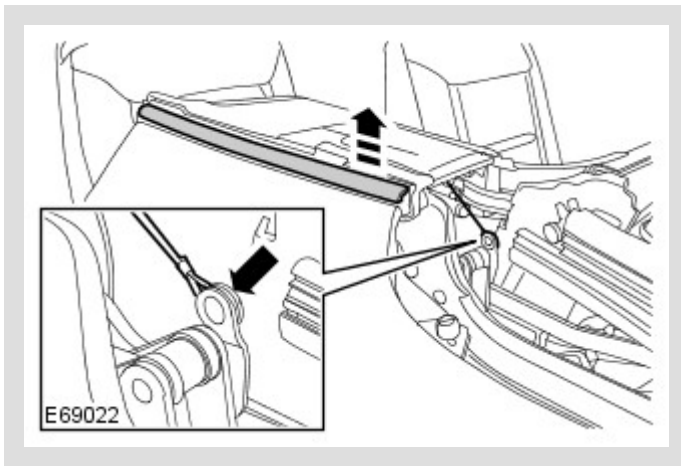

Carefully remove the outer waist seal.

Release each end of the seal from the body.

8.

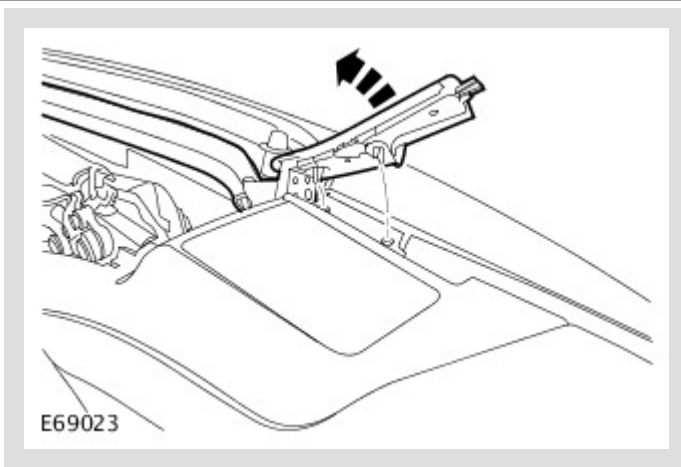

Release the convertible top lid seal.

Release from the 2 clips.

9.

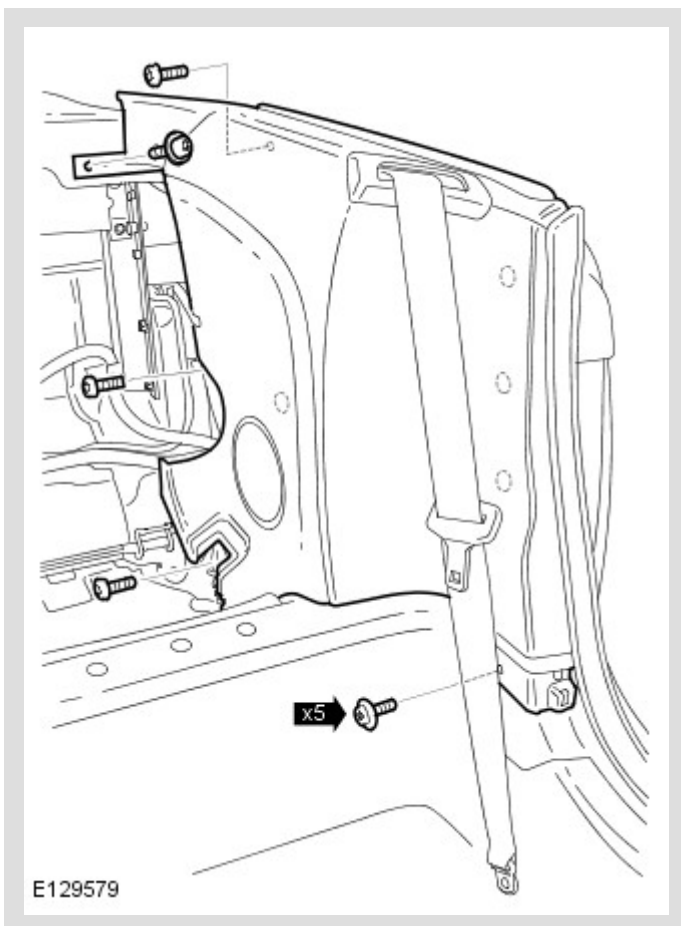

Release the rear quarter trim panel.

Remove the 5 Torx bolts.

Release from the 4 clips.

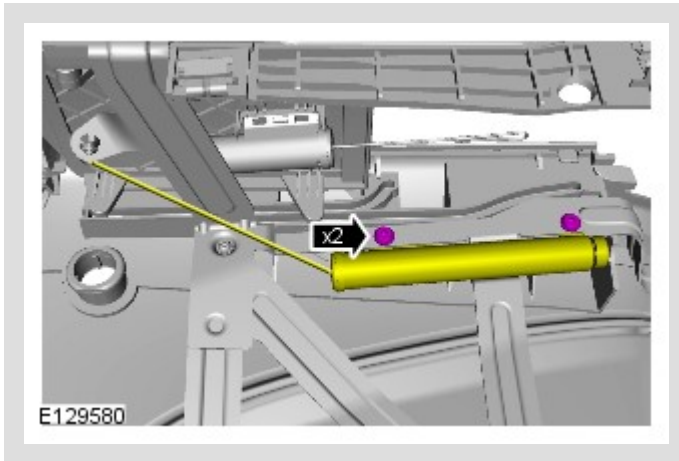

Release the air damper unit from the trim panel.

11.

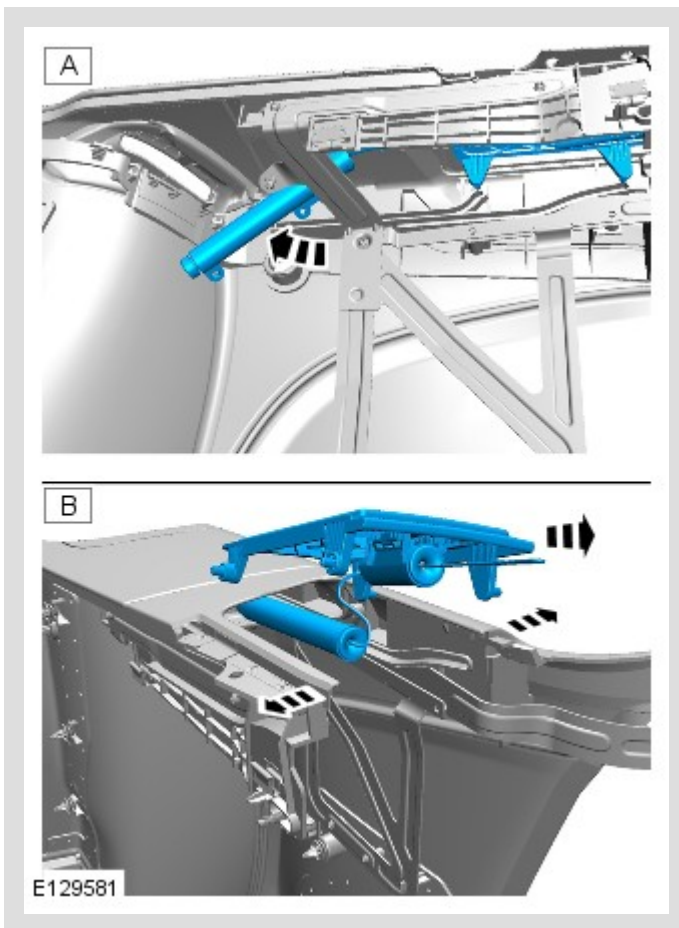

Remove the rear quarter trim sliding panel complete with both air damper units

Carefully release the rear quarter trim sliding panel.

INSTALLATION

1. Carefully install the rear quarter trim sliding panel.

Position the air damper unit between the quarter trim panel and the support brace.

2.

Install the air damper unit to the trim panel.

Tighten the Torx screws to 1.9 Nm (1.4 lb.ft).

3.

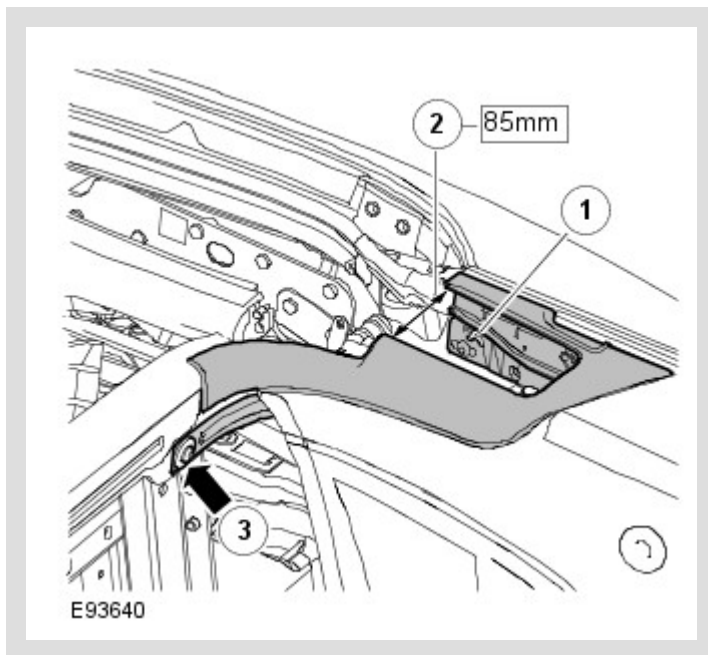

Install the rear quarter trim panel.

Secure with the clips.

Check the illustrated trim dimension, before tightening the Torx bolts to 3 Nm (2.2 lb.ft).

4. Attach the convertible top lid seal.

Secure with the clips.

5. Install the outer waist seal.

Attach the outer waist seal to the body.

6. Attach the convertible top hinge cover tension strap.

Attach to the convertible top mechanism.

7. Close the convertible top.

Depress the switch.

8. Install the scuff plate trim panel.

Secure in the clips.

Tighten the Torx bolt to 10 Nm (7 lb.ft).

9. Install the safety belt stalk.

Tighten the Torx bolt to 45 Nm (33 lb.ft).

10. Install the rear safety belt stalk trim panel.

Secure with the clip.

11. Install the rear seat backrest.

For additional information, refer to: Rear Seat Backrest (501-10, Removal and Installation).